

MOUNTING INSTRUCTIONS

DECK TILES:
COSMOPOLITAN
MOSAIC
NATURAL STONE

EASY AND QUICK INSTALLATION:

- Read the instructions carefully before installing the tiles.
- No special tools are required.
- Tiles can be laid on existing floors and substrates that are robust, smooth, dry, even, securely fixed and clean
-

NECESSARY TOOLS:



Hand knife, with heavy duty blade

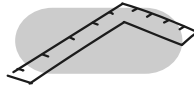

Straight edge



Pencil or chalk marker



Measuring tape

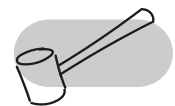

Rubber mallet - optional

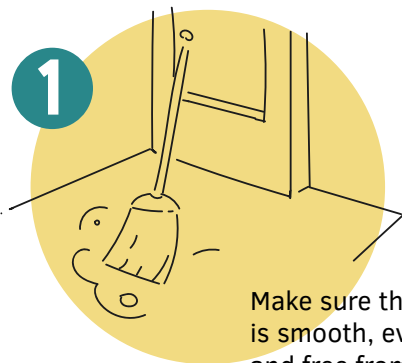

1

Make sure the floor surface is smooth, even, dry, clean and free from grease and oil. Check for cracks, gaps, nails or other damage. Patch or fill any large holes.

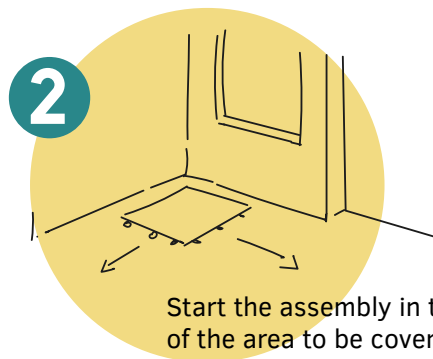

2

Start the assembly in the corner of the area to be covered. Lay the first tile, making sure that the „smooth” edges are facing left and up and the tabs are facing right and down.

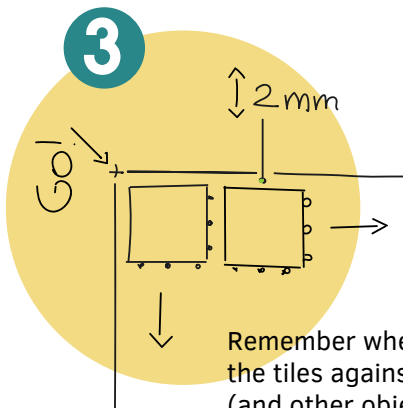

3

Remember when laying the tiles against a wall (and other objects) to leave approximately 2 mm gap for each tile.

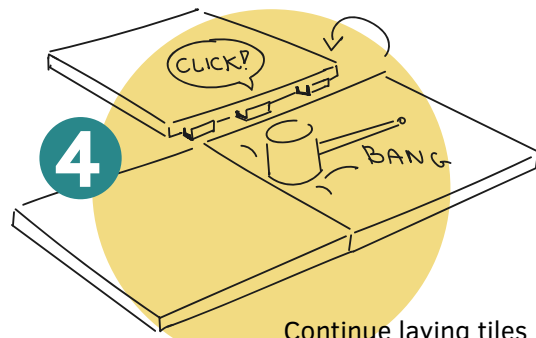

4

Continue laying tiles until the desired area is covered.

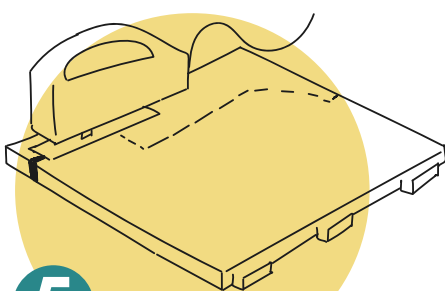

5

When you reach walls or obstructions you will probably need to cut tiles to align them with the wall. Measure the distance between the last tile and the wall and cut off the excess tile.