

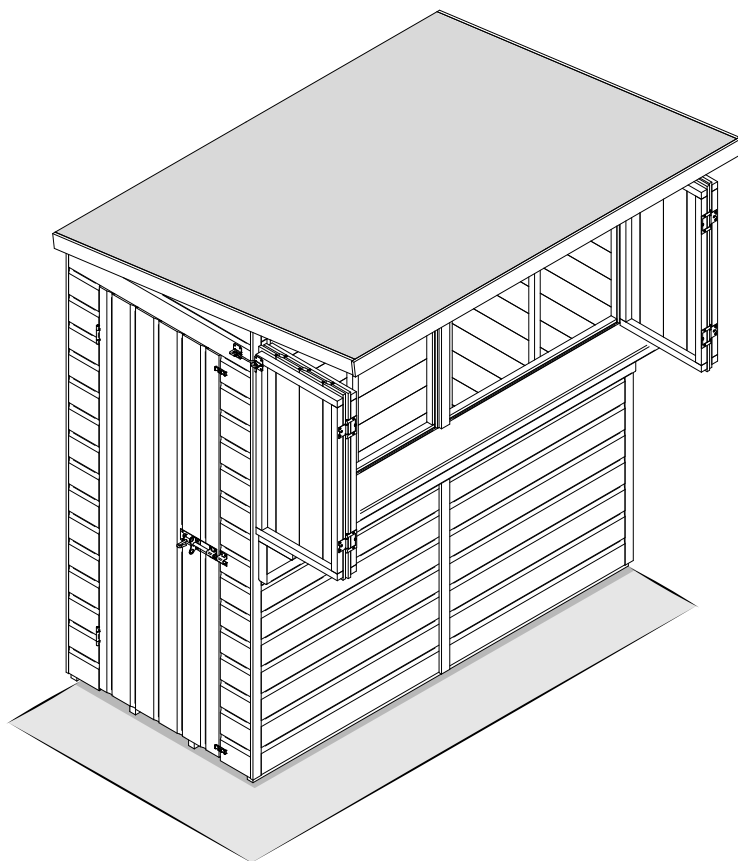

Making British gardens great

Thank you for purchasing your yard bar from Forest Garden. Simply follow these step-by-step instructions and our top tips, and you'll be enjoying your yard bar for many years to come. If you have any questions or need advice, our friendly team is here to help.

# SHIPLAP YARD BAR INSTRUCTIONS (6x3)



**Missing something or need more information?**

Call our aftersales team on  
0333 321 3142

**Visit our website for spare instructions and  
more information**

[www.forestgarden.co.uk](http://www.forestgarden.co.uk)

Forest Garden, Oak Drive, Hartlebury Trading Estate, Hartlebury, Worcestershire, DY10 4JB  
EU Authorised Representative: Authorised Representative Service, 77 Camden Street Lower Dublin, D02 XE80, Ireland  
Tel. +353 1697 2151 E-mail: [contact@arenquiries.com](mailto:contact@arenquiries.com)

## BEFORE YOU START

Please read through these instructions to familiarise yourself with your yard bar. We recommend that you **check all the components and fixings**. Your **fixings** can be found on **page 6** and your parts list can be found at the end of this document.

## BASE PREPARATION

It is vital that you build your new yard bar on a **solid, level base**. Timber or Plastic Shed Bases are ideal, as is solid concrete or concrete slabs.

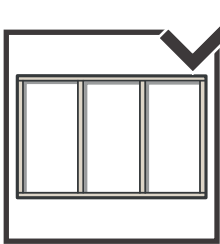

**Timber Base**

Self-constructed/  
Buy pre-made

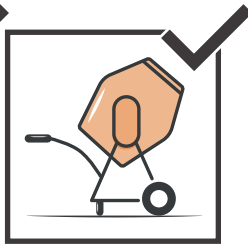

**Concrete**

Concrete surface/  
Concrete slabs

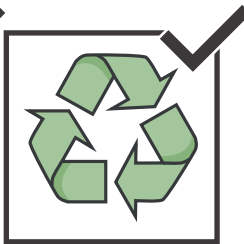

**Pro Shed Base**

Interlocking  
eco-friendly base

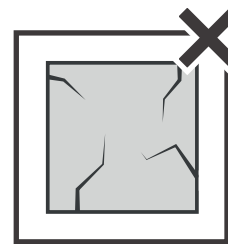

**Broken Slabs/Gaps**

Uneven slab sizes  
with no cement

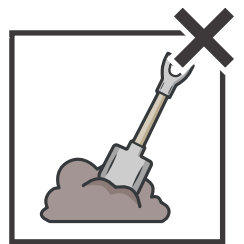

**Soil**

A base of soil or  
grass only

If you have an existing base and think it is suitable for your new yard bar to be sited on, it is important you check that it is level and does not deviate by any more than 15mm from edge to edge. If this is not the case the building will twist, causing gaps to appear in the sections and the roof, doors, and windows to misalign.

There is more information on base preparation on our website [www.forestgarden.co.uk](http://www.forestgarden.co.uk)

## TOOLS NEEDED

We recommend using the following tools (not supplied):

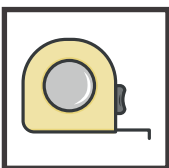

Tape Measure

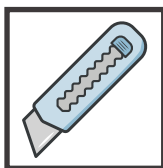

Sharp Knife



PZ2 Pozidriv  
Screwdriver

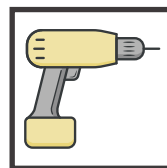

Drill & 2-6mm  
Drill Bits

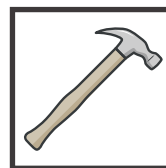

Hammer

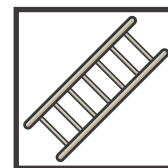

Fit For Purpose  
Ladder

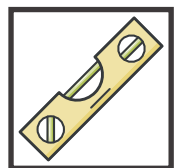

Spirit Level

We recommend getting everything aligned properly before screwing together and that the **screw holes are pre-drilled** at this stage to **avoid splitting the timber**. We do not provide pre-drilled holes due to the nature of expanding and shrinking timber, which can cause pre-drilled holes to misalign.



### IMPORTANT

Assembly requires 2+ adults.



### REMINDER

Always pre-drill before screwing.

PLEASE KEEP PLASTIC BAGS AND SMALL PARTS AWAY FROM CHILDREN.  
CHECK AND TIGHTEN ALL THE FIXINGS APPLIED TO THIS PRODUCT ON A REGULAR BASIS.

## CARE & ATTENTION

To help you get the most out of our products it is useful to know a little more about the properties of timber, what is normal and how your yard bar may behave as the seasons change. Wood is an extremely durable material for construction but as a natural product when used outdoors it is susceptible to changes in the environment.

### THINGS THAT YOU MIGHT SEE IN YOUR PRODUCT



#### MOVEMENT, TWISTING & WARPING

Wood contains a natural level of moisture so decreasing humidity levels in the surrounding air may cause panels to change their shape as the porous fibres shrink. This can be exaggerated during prolonged periods of dry weather. Movement and gaps in timber products are normal, in most cases the wood will revert to its original form once the high temperatures subside and there is more moisture content in the air. Similarly, in the winter months, the opposite may occur with wood swelling.



#### EXPANSION, CONTRACTION, SPLITS & CRACKS

All timber will expand and contract according to its environment. As a result of this expansion and contraction, it is very common to see splits and cracks developing in the wood. Splits are common during the spring and summer months as the wood begins to dry out. The outer surface dries first and contracts, contracting over a still expanded core of the wood. The result of this is that splits and cracks appear along the grain of wood. These splits are not a fault and do not affect the structural integrity of a product.



#### MOULD & BLUE STAIN

Mould is a surface-dwelling fungus that feeds on the nutrients and debris contained in the surface cells of timber. The most common problems associated with mould are discoloured timber and an increase in permeability of the timber. Blue stain is part of the same family but penetrates deeper into the surface layers of the timber. It stains the timber a dark blue, whereas mould is usually black. These do not cause the timber to rot. Keep the building well ventilated to avoid mould.

#### ADVICE ON FELT HANDLING & USAGE

Roofing felt is flexible at temperatures above 5°C. In cold temperatures extra care must be taken when handling and installing to prevent cracking and damage to the felt. The felt should not be rolled, folded, or used in temperatures lower than 5° C. In cold temperatures the felt should be stored above 10°C (indoors) for 24 hours prior to use. Felt must be lifted, not dragged, and should be stored on its end on a dry surface.

### 8 TOP TIPS TO ENSURE YOUR YARD BAR IS FULLY WATERPROOF

- 1 POSITION YOUR YARD BAR IN THE BEST LOCATION IN YOUR GARDEN**  
 Avoid areas where water pools and which are constantly wet. Position away from trees and cut back any overhanging foliage which can cause moisture to be trapped against the walls and debris to collect on the roof.
- 2 RAISE YOUR YARD BAR OFF THE GROUND**  
 Ideally, any concrete base should be the same footprint as the yard bar to allow surface water to run off without pooling. A timber base can also be used. Raise your yard bar 50mm above ground level.
- 3 SEAL THE BEARERS**  
 If using a wooden base, we recommend treating it with a treatment containing wax or oil. Also coat the bearers that meet the ground to prevent moisture rising.
- 4 USE AN END-GRAIN PROTECTOR**  
 To protect the corners and panel joins, an end grain protector can be applied.
- 5 SEAL THE PANELS & WINDOWS**  
 Use a flexible silicone sealant around windows to prevent water ingress. This can also be used where two sections of the yard bar join together. Apply internally.
- 6 CONSIDER ADDING GUTTERS**  
 Adding guttering around the fascia of the yard bar will redirect rainwater away from the yard bar's foundation.
- 7 KEEP VENTILATED**  
 Good airflow around the perimeter of the yard bar and regular ventilation inside the yard bar will help prevent mould and mildew.
- 8 CONSIDER A WATER SEALANT**  
 You may want to consider painting your yard bar with a water sealant at least once a year. This will help reduce the risk of water ingress. We would recommend using 'Bostik Cementone Water Seal' of which can be purchased from multiple DIY stores.

## HEALTH & SAFETY

We strongly recommend that PPE (Personal Protective Equipment) is used throughout your build to ensure you are protected from any potential health and safety risks. **Do not exempt yourself from wearing PPE.**

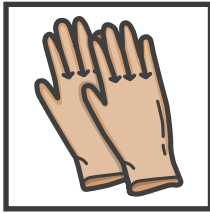

Cut-Resistant  
Gloves

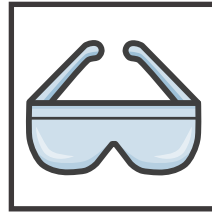

Protective Glasses

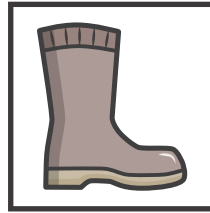

Protective Boots

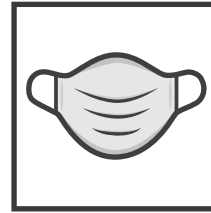

Protective Mask

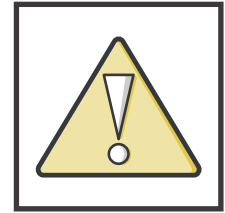

Working At  
Height

### THE ROOF OF THIS BUILDING IS NOT A LOAD BEARING STRUCTURE.

The components provided may be heavy. Please lift with caution and with a minimum of 2 people. Please carefully unpack your garden bar and loose components as they may have moved during transportation.

## TREATMENT INFORMATION

The treatment applied to your yard bar is to ensure longevity and protection against fungal decay and rot. This may leave colour variations, but these will even out as the moisture content stabilises.

Pressure Treatment
Pressure treatment is to provide protection against rot
Pressure treated garden bars do not need to be re-treated every year
25 year guarantee

Use the 'waterproofing top tips' to increase the longevity of your yard bar. See our website for more information at [www.forestgarden.co.uk /guide-to-our-products/](http://www.forestgarden.co.uk/guide-to-our-products/)

### Treated timber contains biocidal products for control of wood destroying organisms.

**Active Ingredients** - Basic Copper Carbonate, DDA Carbonate, DDA Chloride.

- Wear gloves when handling.
- Avoid inhalation of sawdust.
- Do not use in contact with drinking water or food.
- Do not use for animal bedding or in fish ponds.
- Dispose of treated wood responsibly.
- Treated products cannot be recycled as the wood is no longer in its original virgin state.
- Once the treatment has dried there is no risk of toxic contamination. The risk would come from the treatment before it is added to our products.

## DISCLAIMER

**Check you have all your parts prior to assembly.**

Timber is a natural material of which will shrink and swell because of varying moisture content.

Assembly of damaged parts may be deemed to be acceptance, and this may affect the remedies you are entitled to.

If the product is not constructed in accordance with the instructions, or is altered in anyway (e.g. painted), the manufacturer cannot be held liable for any resulting damage.

If you are organising a third party to install your yard bar, it is best not to schedule this immediately on receipt of your order, to give you time to check your delivery.

# YARD BAR PANEL LAYOUT

Use the **floor plan** below, to identify the side panel positions before assembling your yard bar.  
Use the key and visuals below as a guide.

## KEY

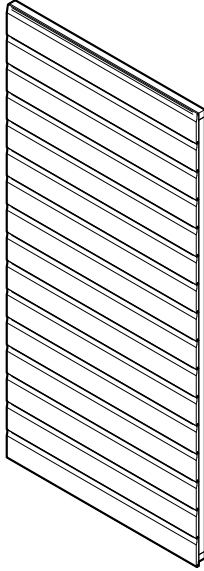

**A** 3ft Plain Panel  
(885 x 1831mm)

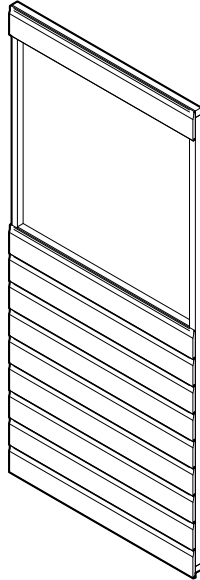

**B** 3ft Window Panel  
(885 x 1945mm)

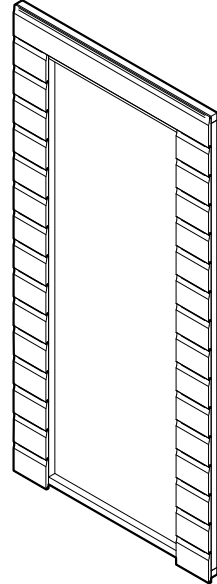

**C** 3ft Door Panel  
(1180 x 1831mm)

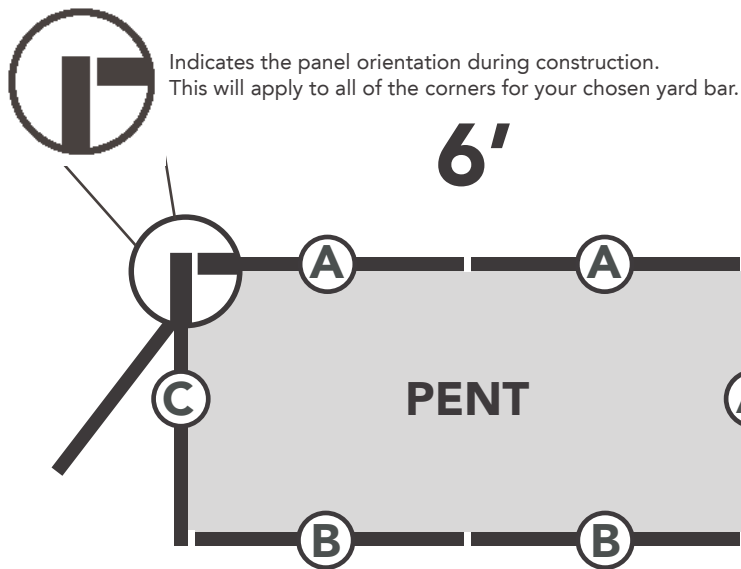

### PLEASE NOTE

The yard bars are made up of multiple sections where same size panels are interchangeable.

### SINGLE DOOR

The door is flexible and can be hinged onto either side.

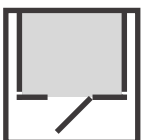

# WHERE IS MY PARTS LIST?

Your parts list can be found at the end of this document with the product code and description. **Check through your parts list prior to assembly.**

## FIXING PACK CONTAINS:

FIXING PACK CODE: SPP63YBARFP

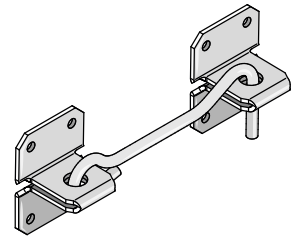
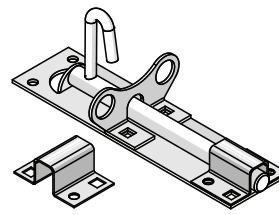
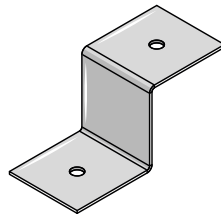
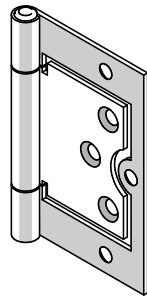
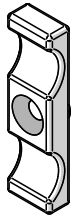
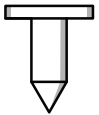

**PLEASE KEEP PLASTIC BAGS AND SMALL PARTS AWAY FROM CHILDREN.  
CHECK AND TIGHTEN ALL THE FIXINGS APPLIED TO THIS PRODUCT ON A REGULAR BASIS.**

# STEP 1: POSITION FLOOR



Before assembly, **your Floor must be firm and level** to ensure the yard bar lines up and is assembled properly. We recommend that there should be **access to all sides of your yard bar for assembly and any maintenance.**

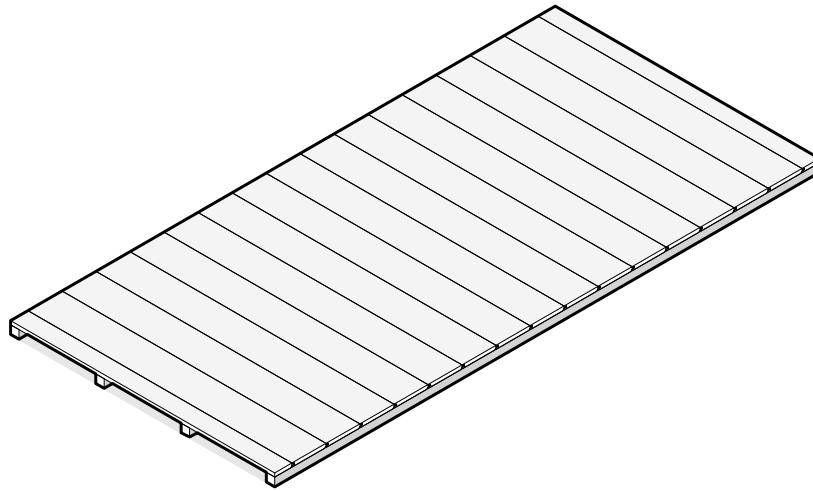

## SINGLE FLOOR

Position the Floor in your desired location.

# STEP 2A: SIDE PANEL PREPARATION

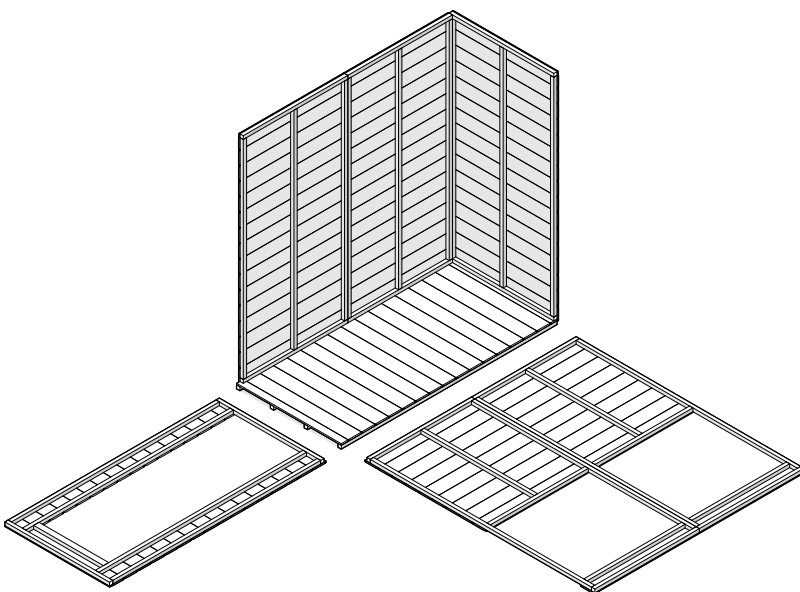
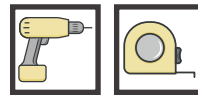

## LAY OUT PANELS

Lay out the panels around your Floor to your desired panel configuration. Use your floor plan on page 5 to confirm panel positions.

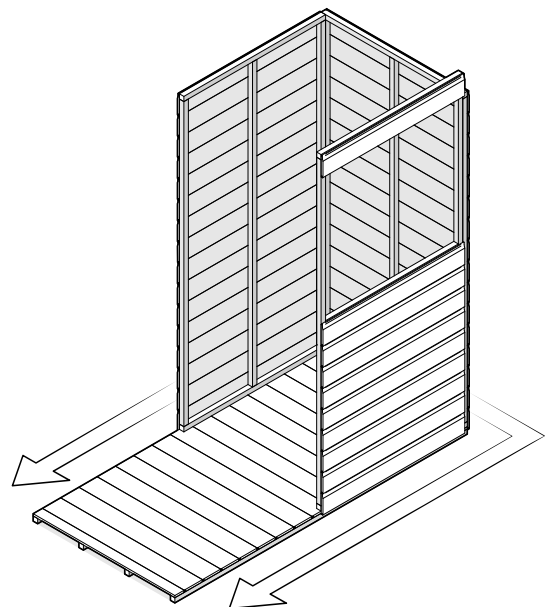

## WORK FROM BACK TO FRONT

We recommend starting in a back corner and then working from the Side Panel to the Door Panel for assembly.

## STEP 2B: SIDE PANEL ASSEMBLY

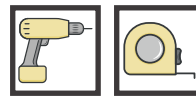

50MM  
SCREWS

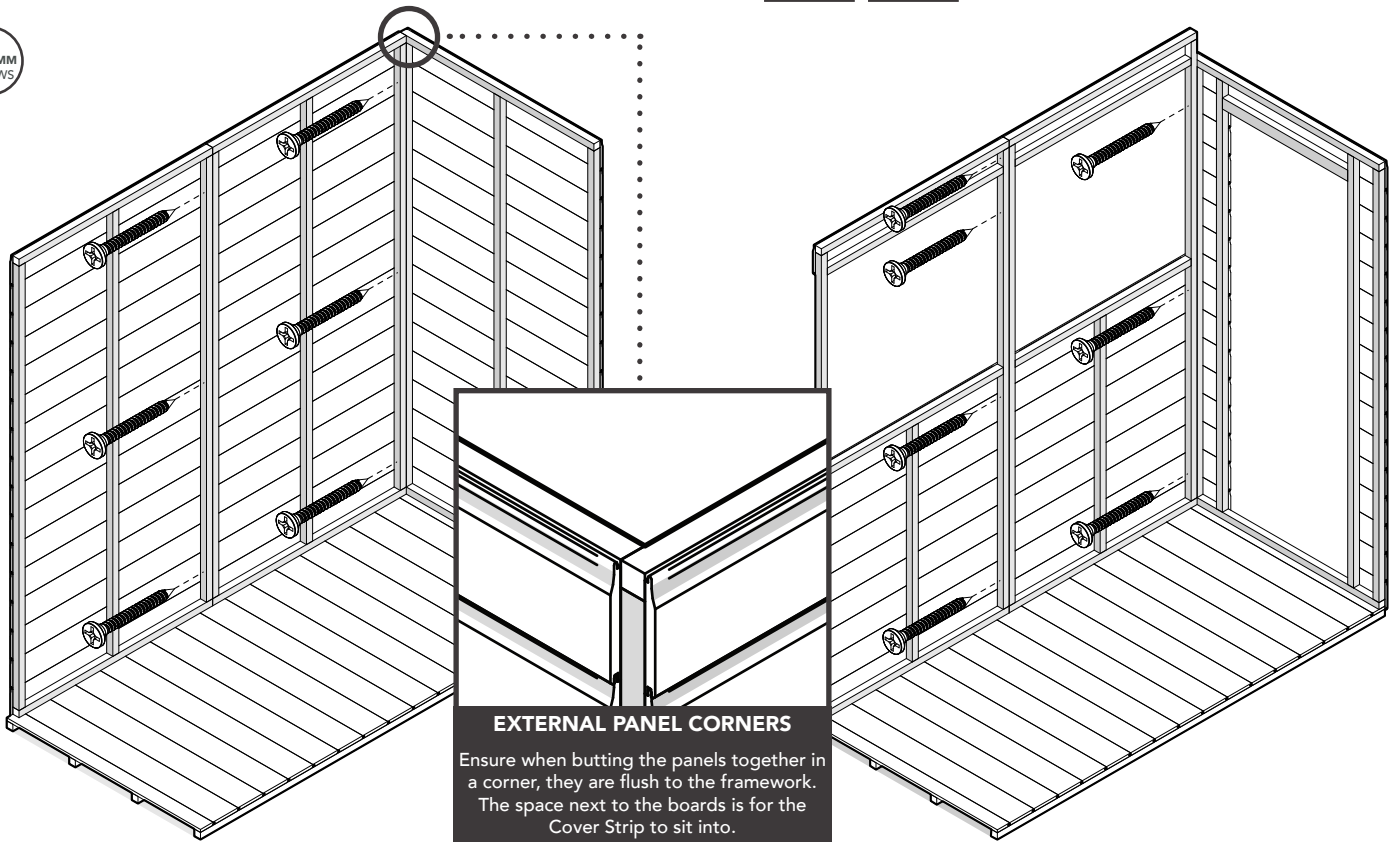

### SECURE PANELS TOGETHER

Position and secure the Side Panels together. Ensure the bottom batten on the Side Panels sit on the Floor with the bottom board up against the Floor edge.

## STEP 2C: SECURE PANELS TO FLOOR

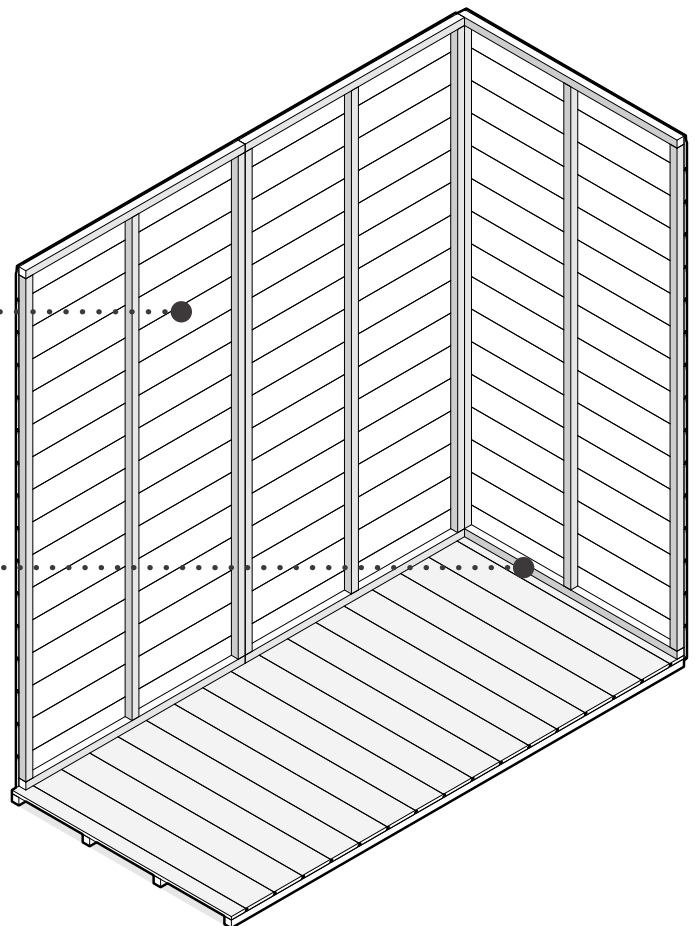
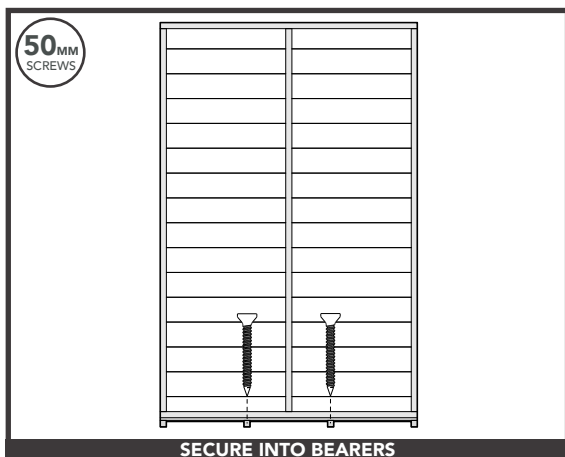
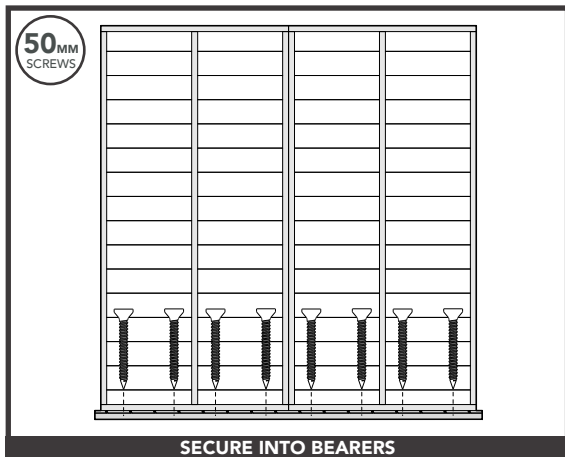



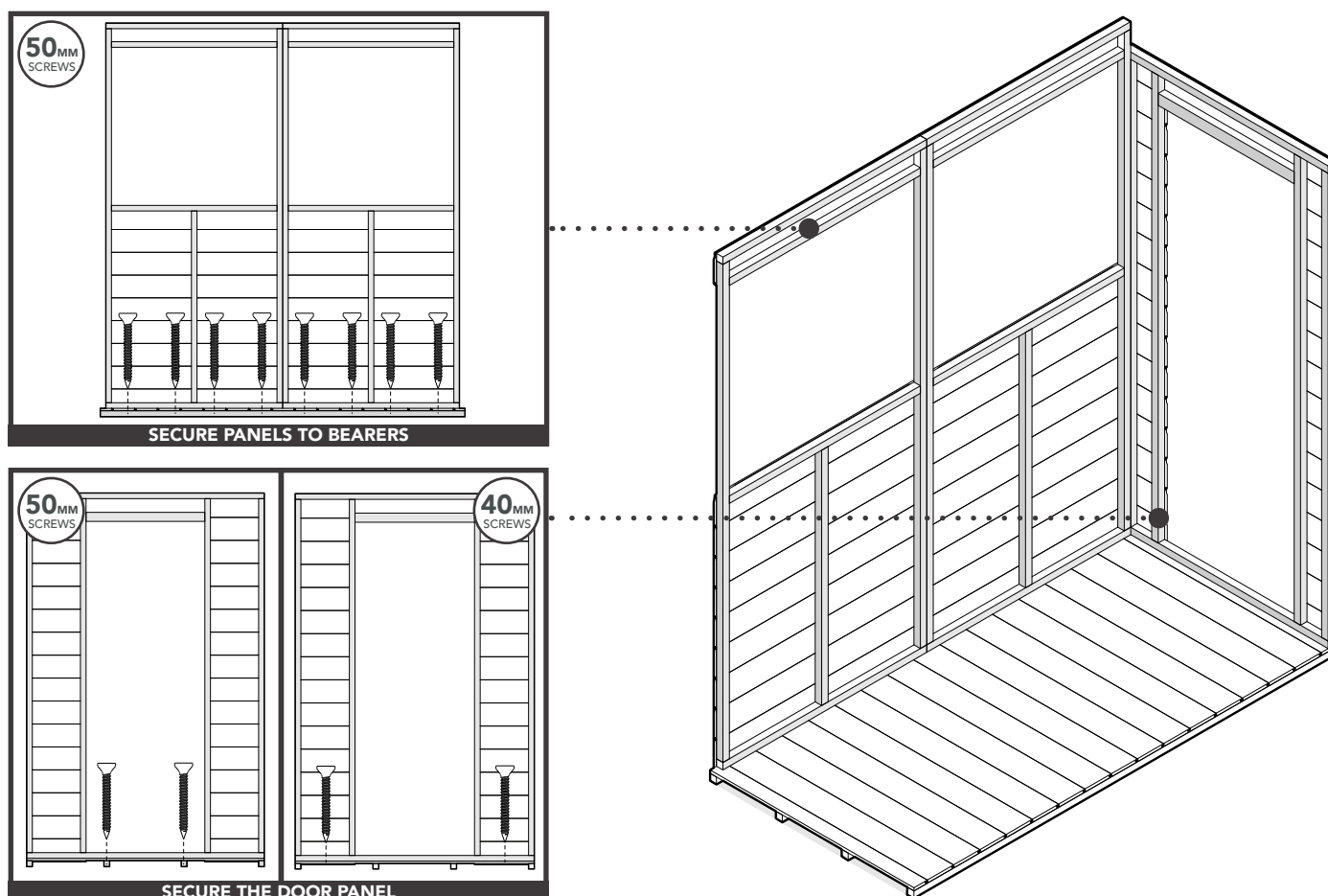

### SECURE TO FLOOR BEARERS/FLOORBOARD BENEATH

Secure the Side Panels to the Floor by **screwing into the floor bearers beneath** using 50mm screws.  
 Secure the Door Panel to the floorboard, only if there are no bearers beneath, using 40mm screws.

## STEP 3: PENT SECTIONS

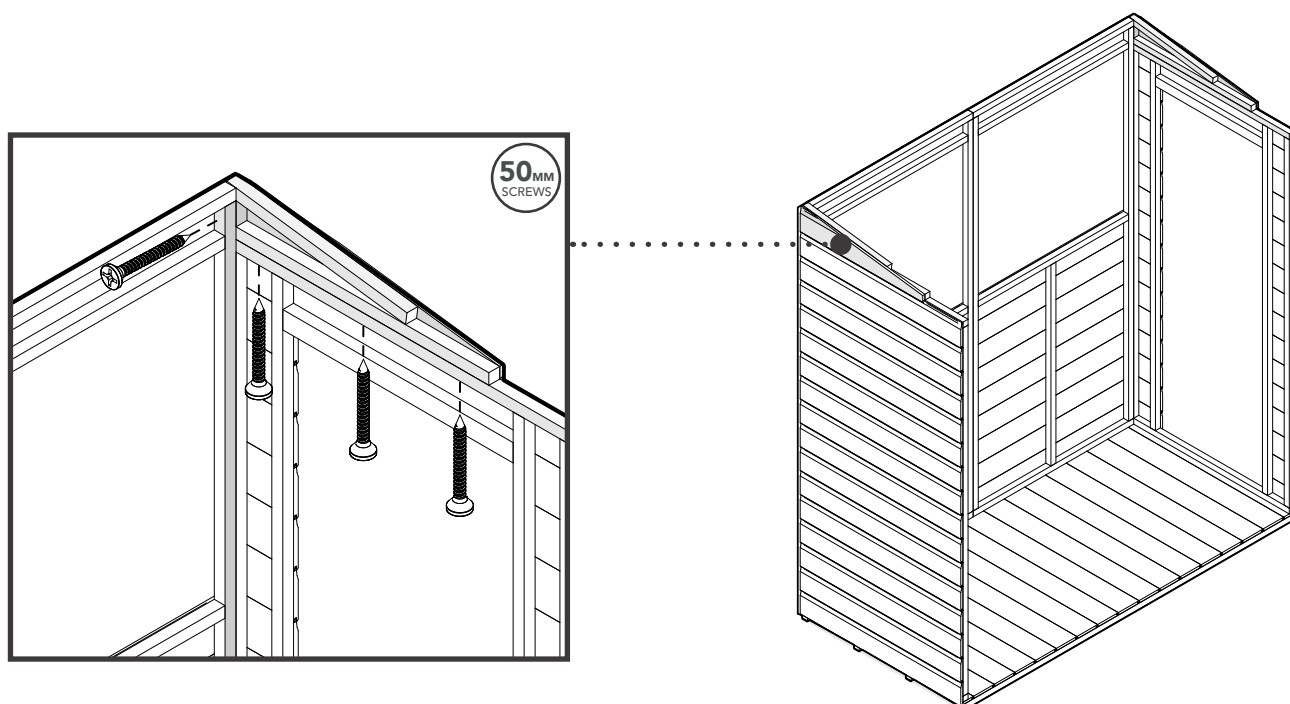
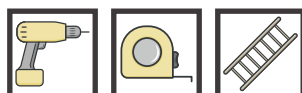

### PENT SECTIONS

Position and secure the Pent Sections to the Side Panel and Door Panel as shown above.

## STEP 4: COVER STRIPS

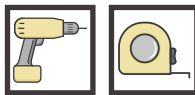

10

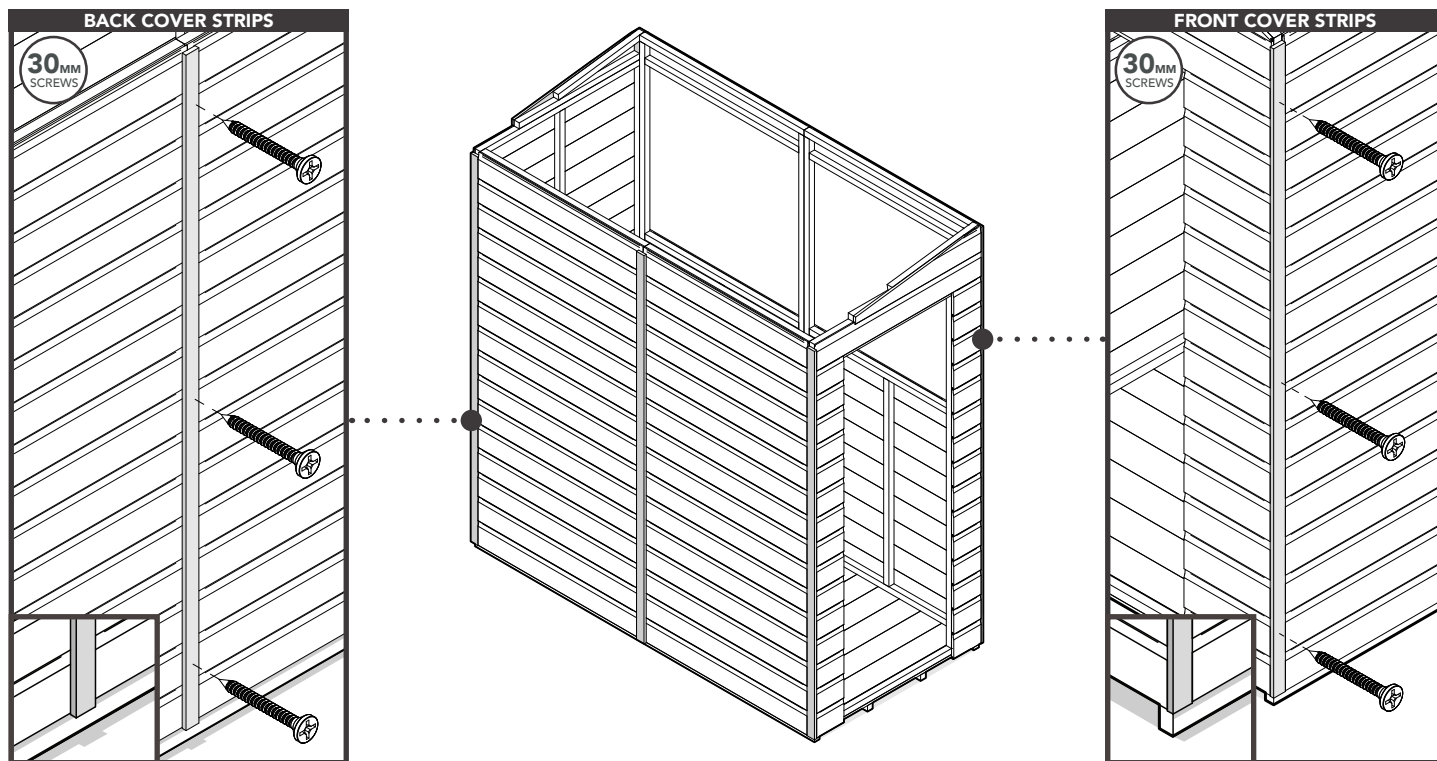

### COVER STRIPS

Secure the Cover Strips to the corners and adjoining panels. Ensure they are flush to the bottom edge of the panels. Make sure to secure the Cover Strips to the framework behind and not into the joins of the panels.

Back Cover Strips size (40x12x1823mm), Front Cover Strips size (40x12x1940mm)

## STEP 5: DOOR STRIPS

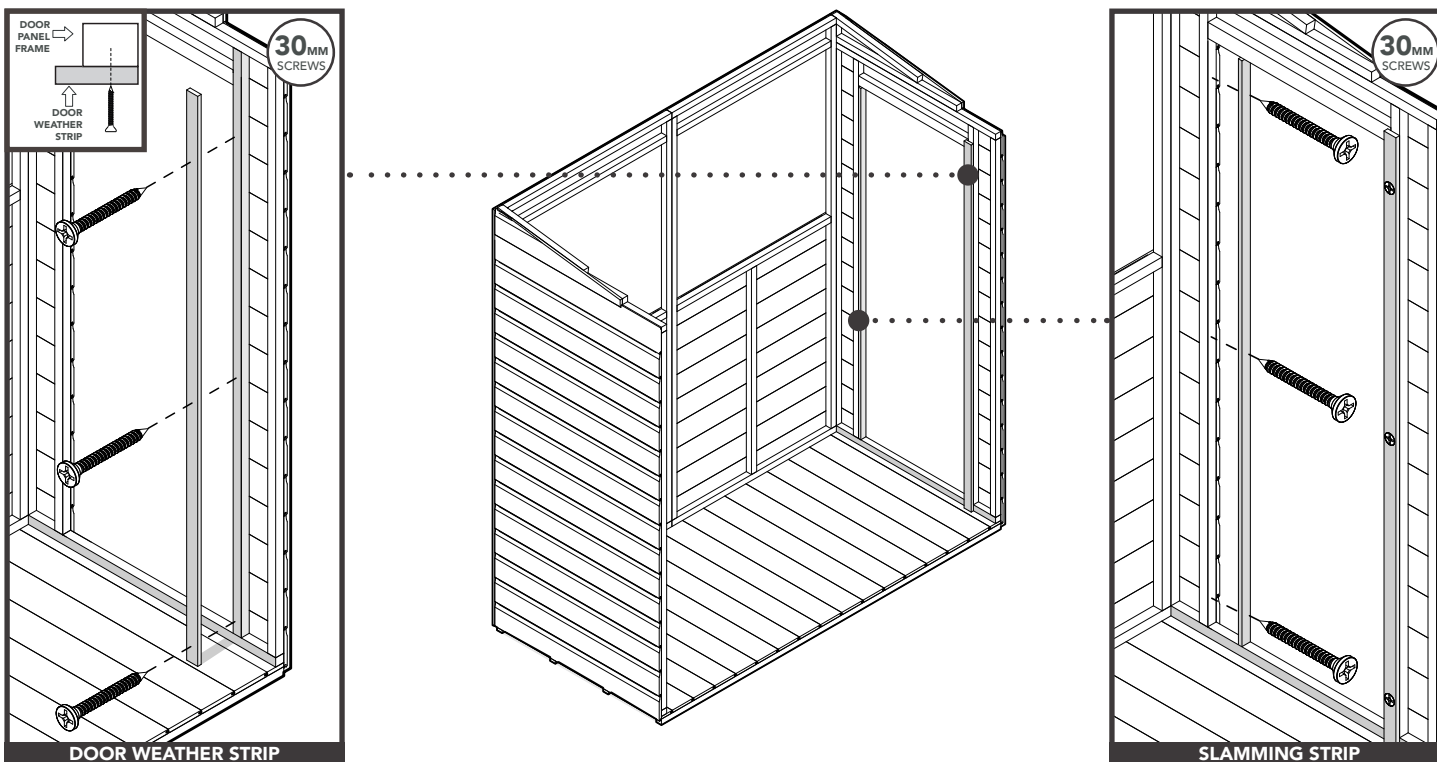
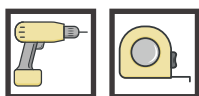

### DOOR WEATHER STRIP

Secure the Door Weather Strip to the side you want the hinges, and ensure it is flush to the Floor and against the face of the Door Panel framework. Ensure there is approximately a 10mm overhang into the door opening.

Door Weather Strip size (38x12x1710mm)

### SLAMMING STRIP

Secure the Slamming Strip, to the Door Panel in the door opening as shown above. This will be on the opposite side you want the hinges.

Slamming Strip size (28x12x1637mm)

## STEP 6A: TABLE ASSEMBLY

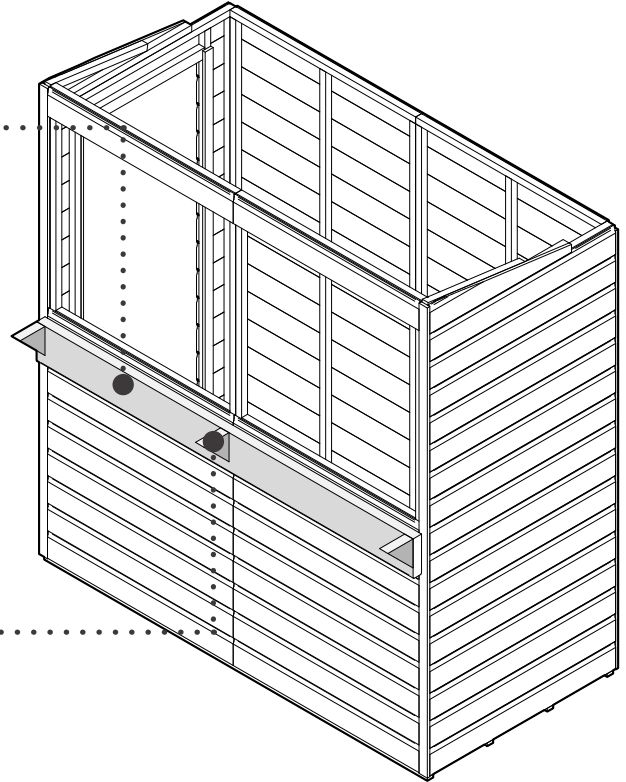
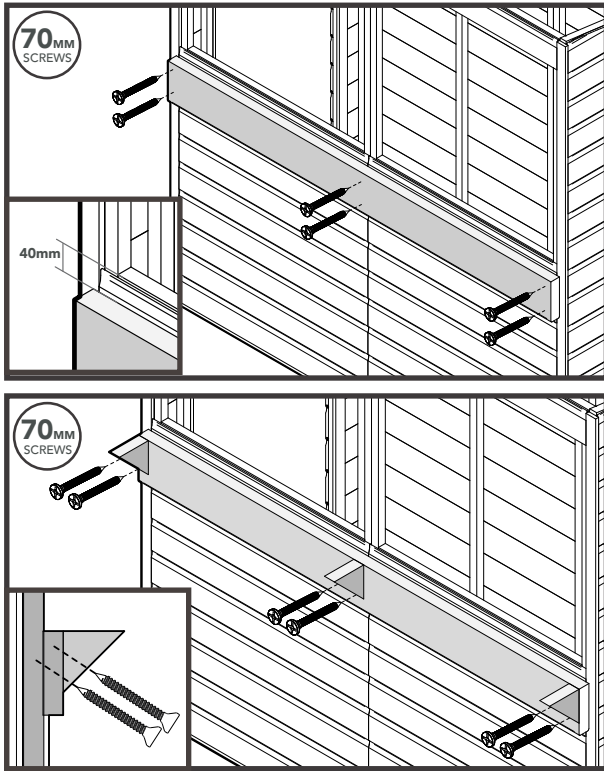
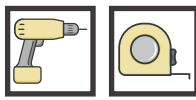

### TABLE ASSEMBLY

Position the Table Back flush to either side of the yard bar. Use the measurement provided and **secure with 70mm screws**. **Secure the Angled Braces to the Table Back**, as shown above.

## STEP 6B: COVER STRIPS

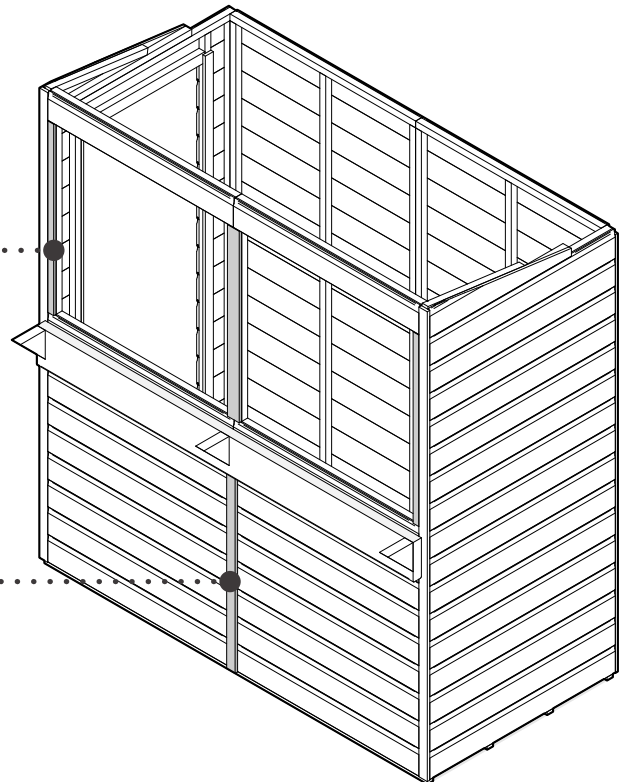
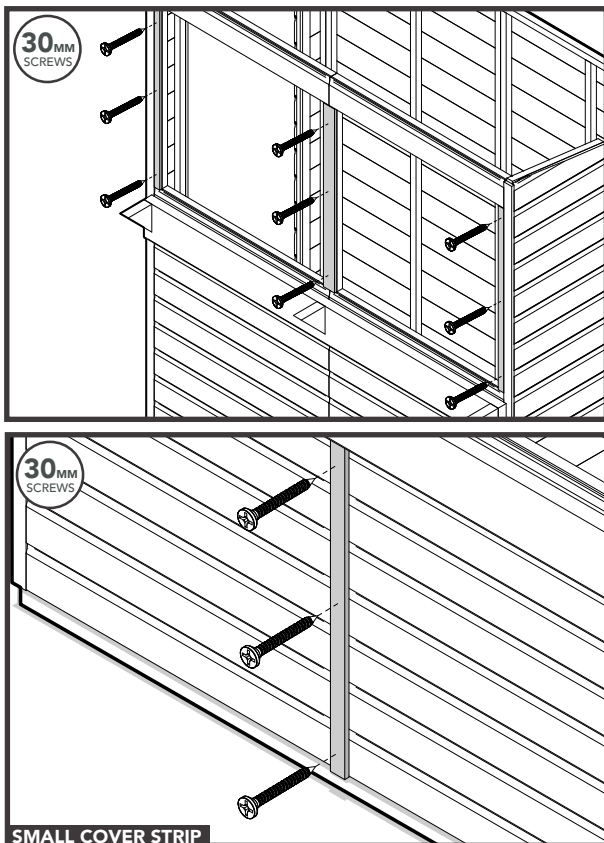
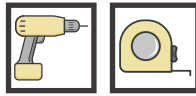

### EXTERNAL WINDOW STRIPS & COVER STRIP

**Position and secure the Window Strips to the window panel framework**, ensuring the wider strip sits between the window openings. **Secure the Smaller Cover Strip to the bottom part of the adjoining window panels**.

Outer Window Strips size (28x12x791mm), Middle Window Strip size (56x12x791mm), Small Cover Strip size (40x12x828mm)

## STEP 6C: INTERNAL WINDOW STRIPS

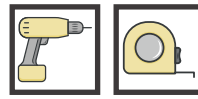

12

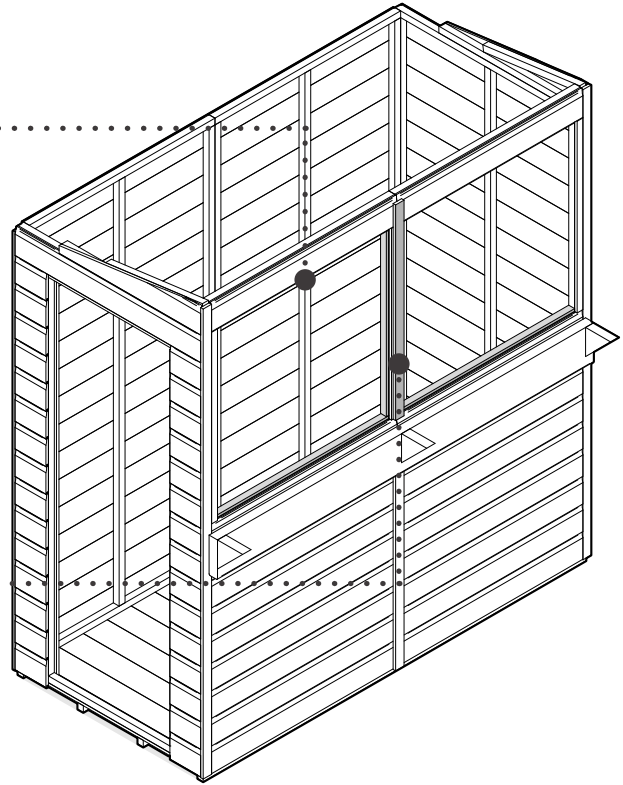
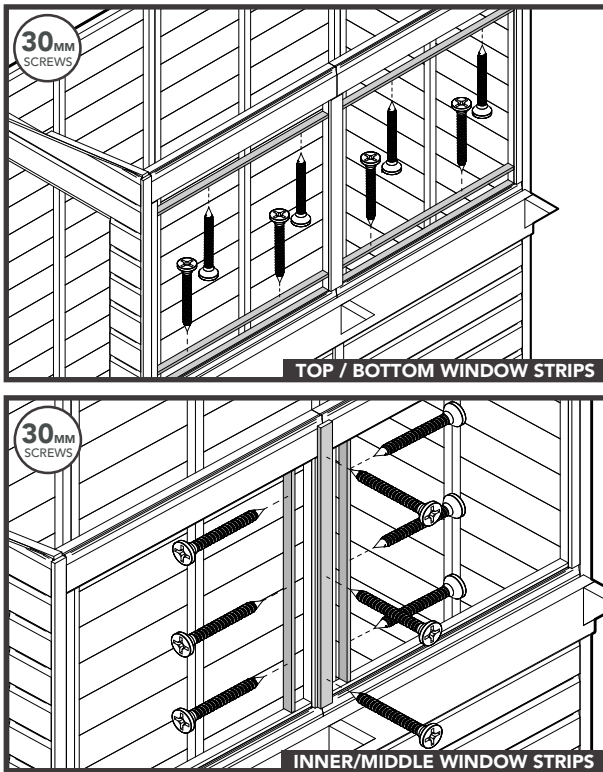

### INTERNAL WINDOW STRIPS ASSEMBLY

Position and Secure the Top and Bottom Window Strips, ensuring they are flush to the window opening. Secure the two Inner Window Side Strips and Middle Cover Strip as shown above.

Top/Bottom Window Strips size (28x12x829mm), Window Side Strips size (28x12x765mm), Middle Cover Strip size (40x12x890mm)

## STEP 6D: TABLE TOP ASSEMBLY

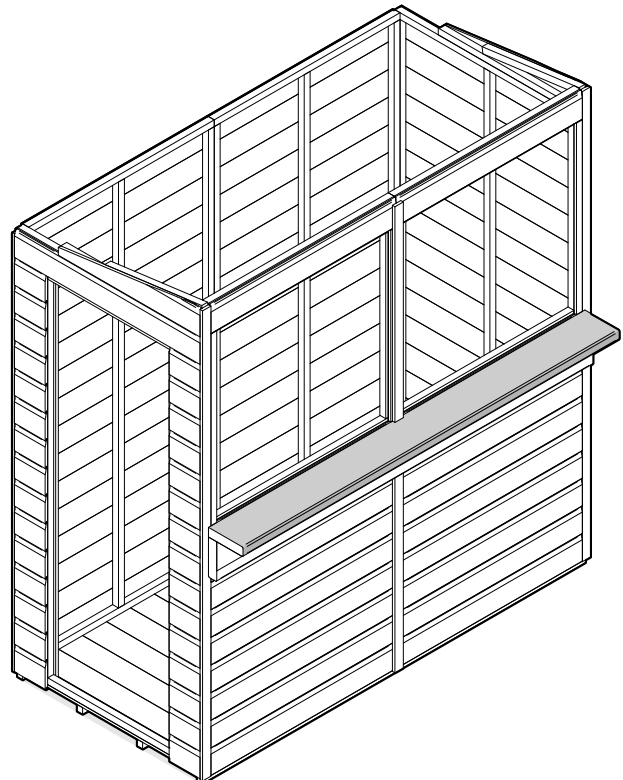
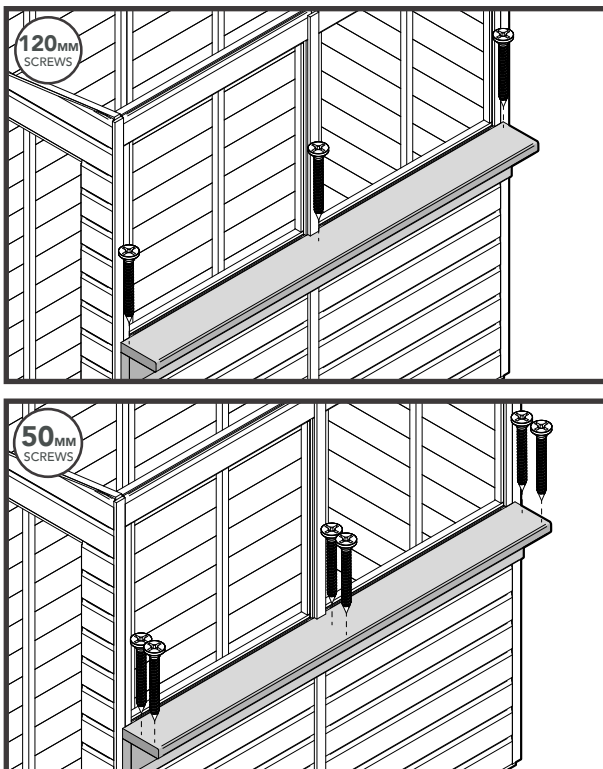
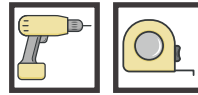

### TABLE TOP ASSEMBLY

Position and Secure the Top Table to the Table Back at each end and in the centre using 120mm screws. Use 50mm screws to secure the Top Table to the Angled Braces.

## STEP 7A: Z-BRACKETS PREPARATION

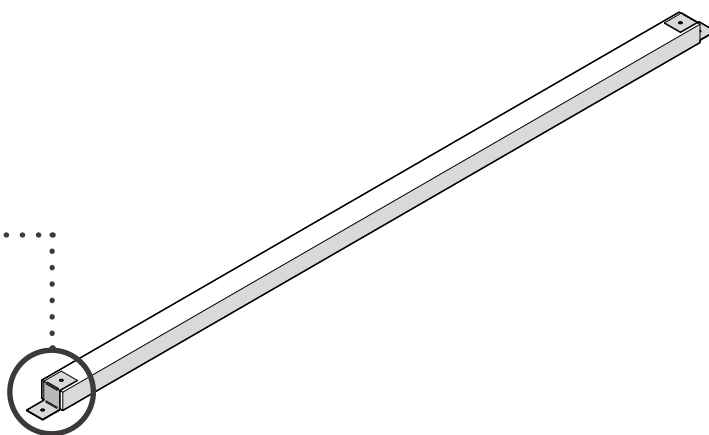
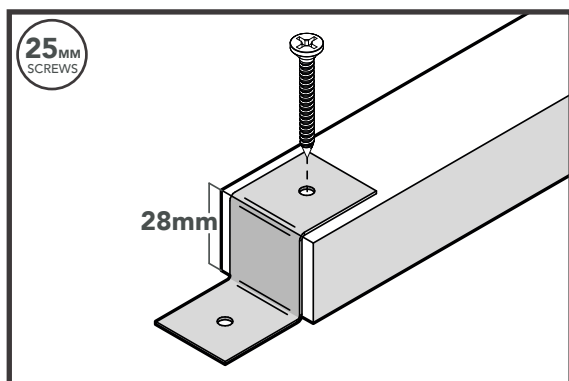
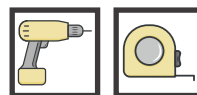

### Z-BRACKETS

Position and secure the Z-brackets to both ends on your Roof Beam as shown above.  
The Roof Beam should be flush to the Z-bracket.

Roof Beam size (45x28x1770mm)

## STEP 7B: ROOF STRUCTURE

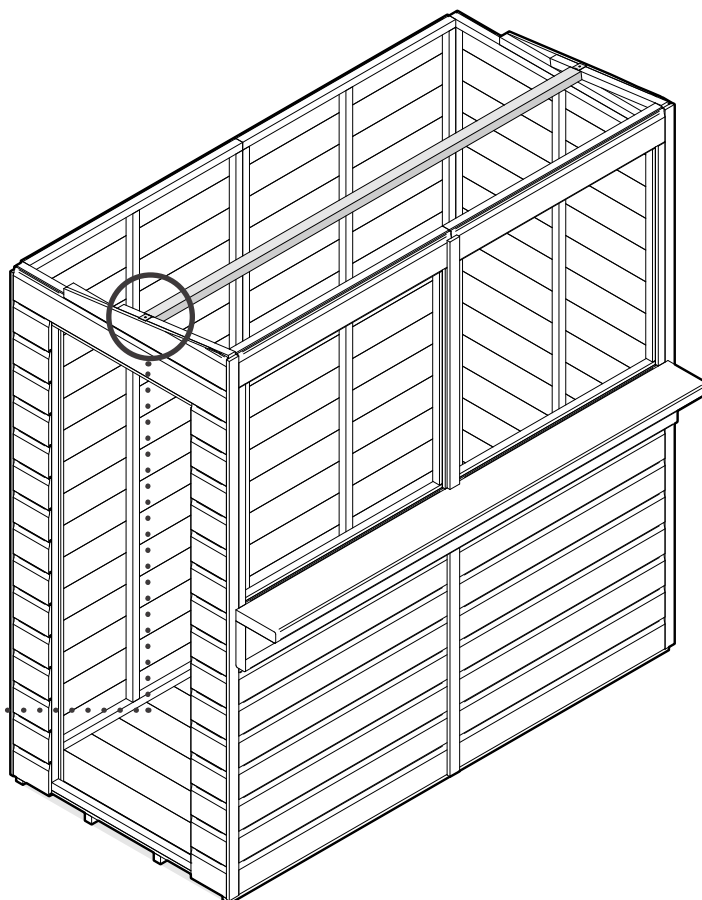
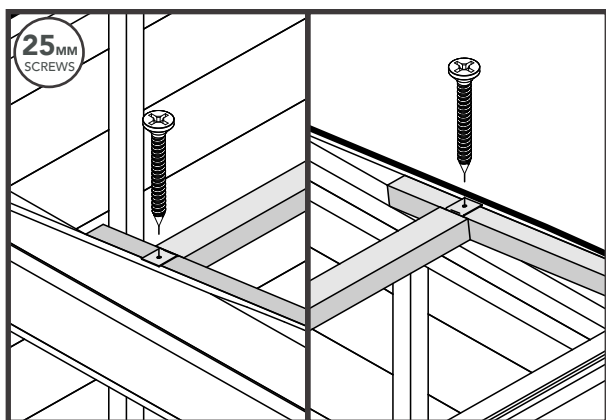
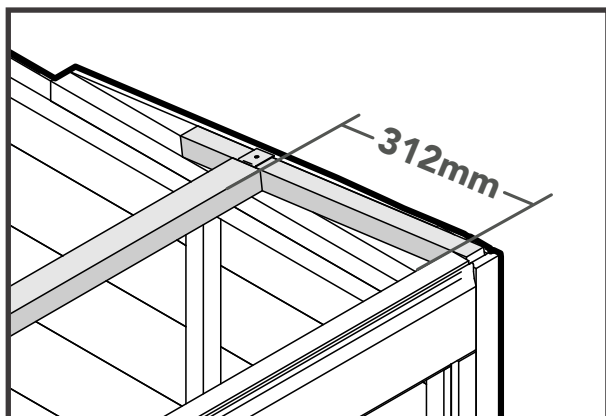
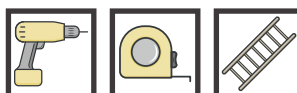

### ROOF STRUCTURE

Position and secure the Roof Beam on to the Pent Sections using the measurements provided.

## STEP 8A: OSB ROOF SHEETS POSITIONING

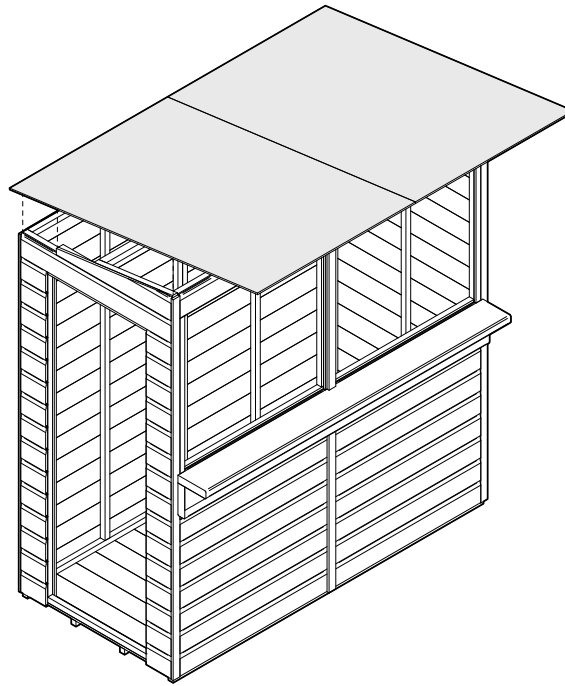
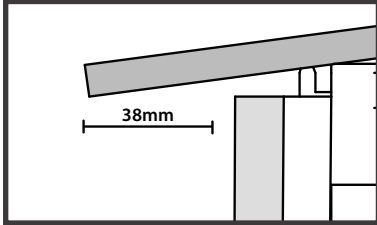

### ROOF POSITIONING

Position the OSB Roof Sheets onto the yard Bar. Ensure the OSB Roof Sheets are flush on both sides with them tightly pushed together. Allow a overhanging of 38mm at the back for the roof battens.

## STEP 8B: ROOF ASSEMBLY

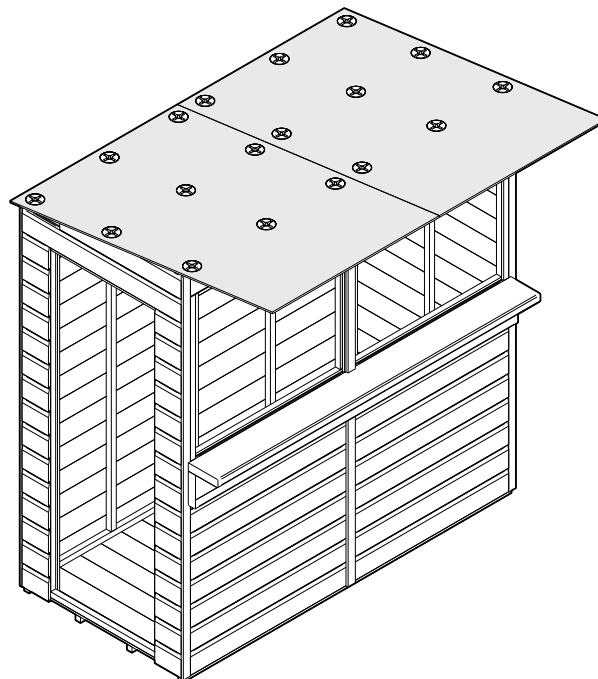
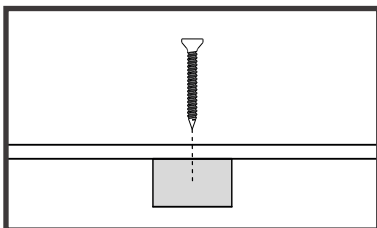
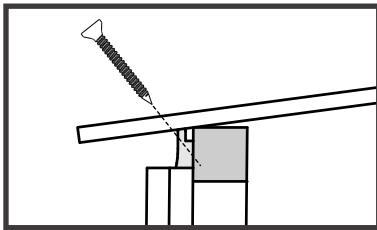

30MM  
SCREWS

### ROOF SHEETS

Position and secure the OSB Roof Sheets to the Pent Sections framework, Side Panels framework and Roof Beam.

## STEP 8C: FRONT AND BACK ROOF STRIPS

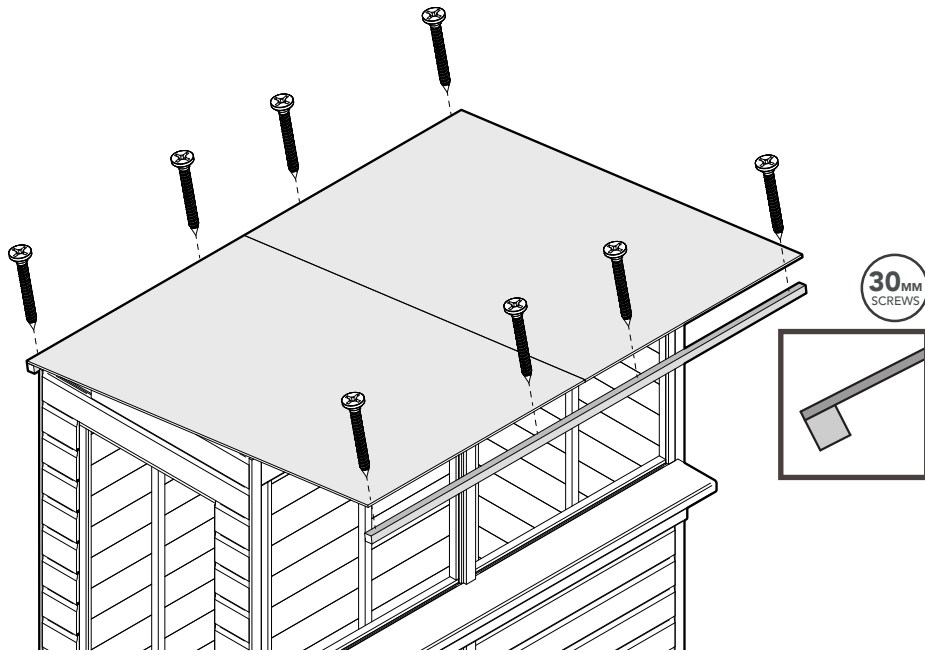
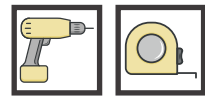

### ROOF STRIPS

Position and secure the **Roof Strips** along the front and back of the OSB Roof as shown above. The Roof Strips will be the same length as the roof. Ensure the Roof Strips are flush to the Roofs edge.

Roof Strip size (28x28x1858mm)

## STEP 8D: OVERHANG STRIPS

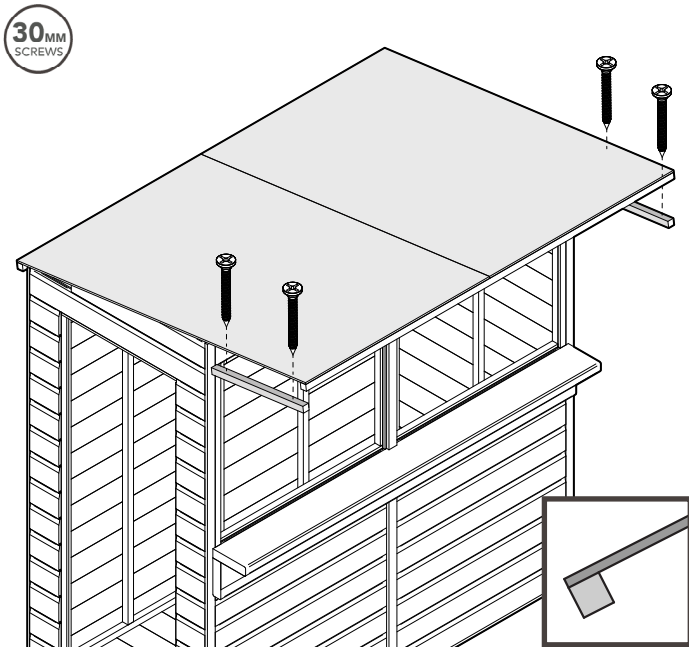
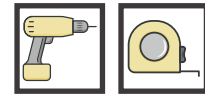

### OUTER ROOF STRIPS

Position and secure the **Outer Roof Strips** along the sides of the OSB Roof as shown above. The Strip will fit into the overhang at the front. Ensure they are flush to the sides of the Roofs edge.

Overhang Strip size (28x28x466mm)

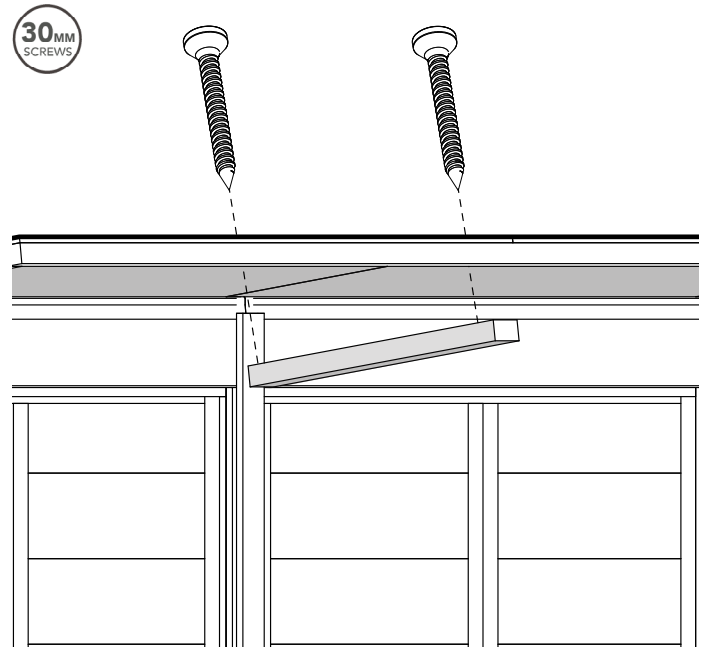

### MIDDLE ROOF STRIP

Position and secure the **Middle Roof Batten** along the join of the OSB Roof as shown above. The Roof Strip will fit into the overhang at the front. Ensure it is central to where to OSB sheets join.

Roof Strip size (45x28x466mm)

## STEP 9: FELT

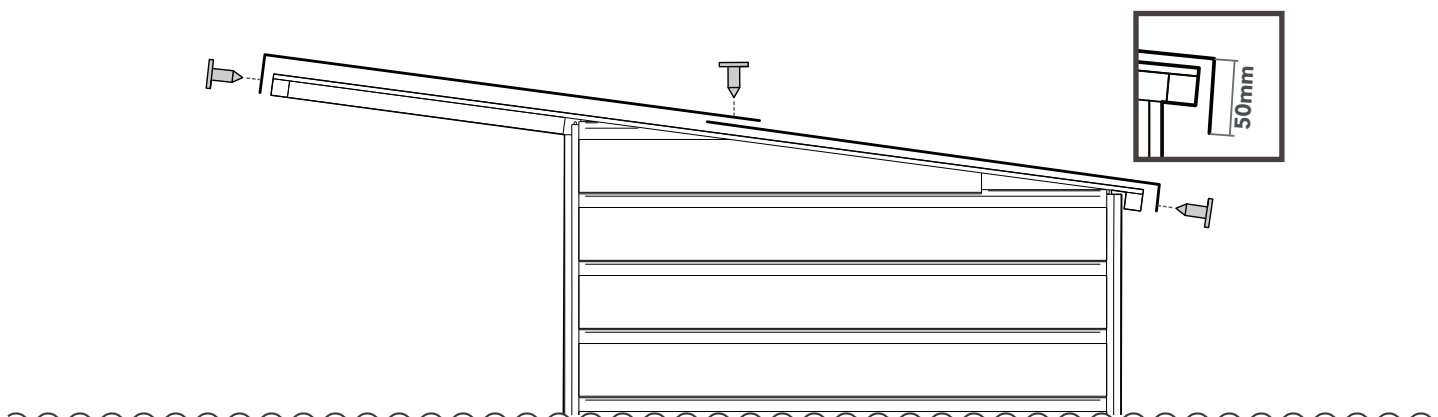
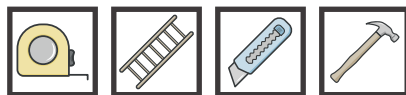

### 2 x FELT PIECES

Measure out 2 equal lengths, cut with a sharp knife, overlap them on top, around the edges and fold the corners; tack to keep secure. Ensure there is a 50mm overhang at the bottom and work from the bottom to the top. Hammer the tacks into the felt at 150mm intervals.

## STEP 10: FASCIA'S

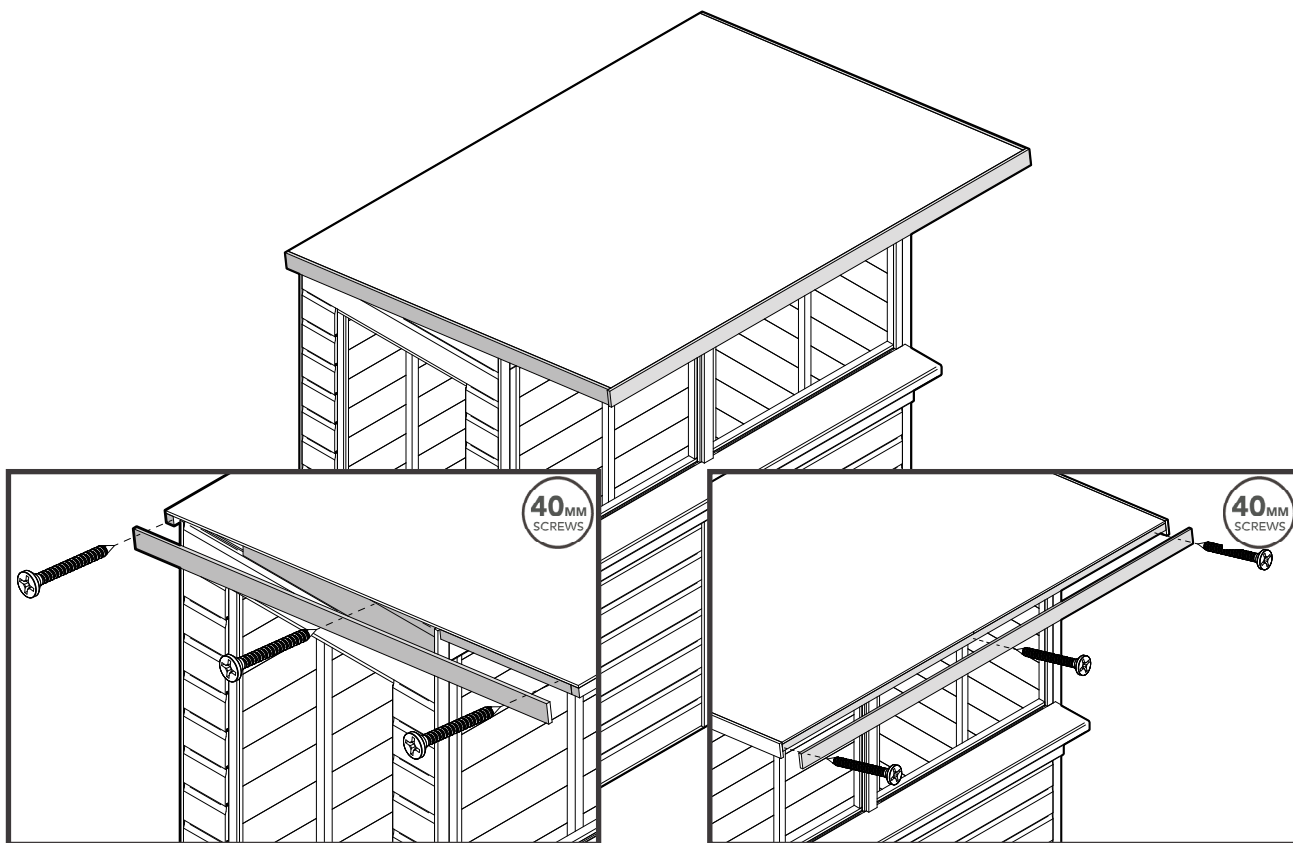
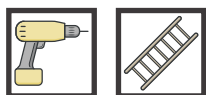

### FASCIA'S ASSEMBLY

Position and secure the Fascia's as shown above, Ensure the Side Fascia's are flush to the front edge. Secure the Fascia's into the Pent Sections framework behind. Secure the Front Fascia into the Roof Strip.

Side Fascia's size (59x12x1471mm), Front Fascia size (59x12x1892mm)



# STEP 11: DOOR HINGES

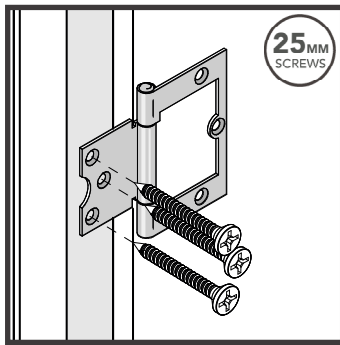
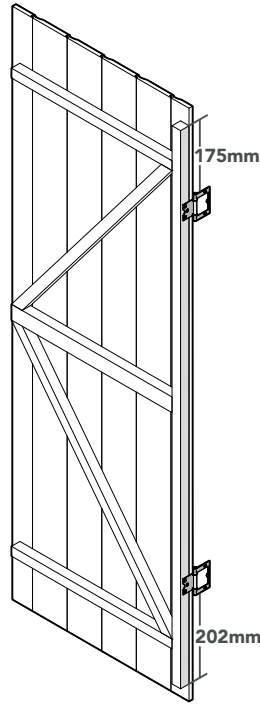
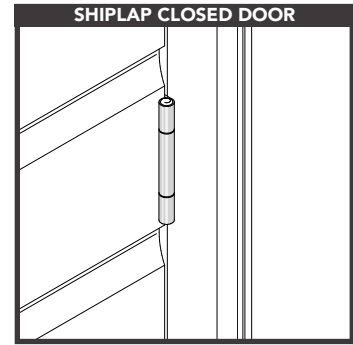
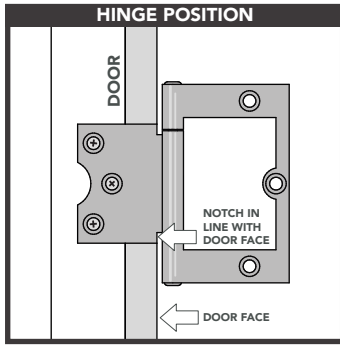
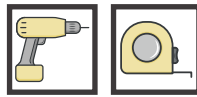

## DOOR HINGES

Secure 2 x hinges to the Door frame with the measurements provided. Please take note of the hinge position. The hinges pin should sit in the centre of the shiplap board as shown above.

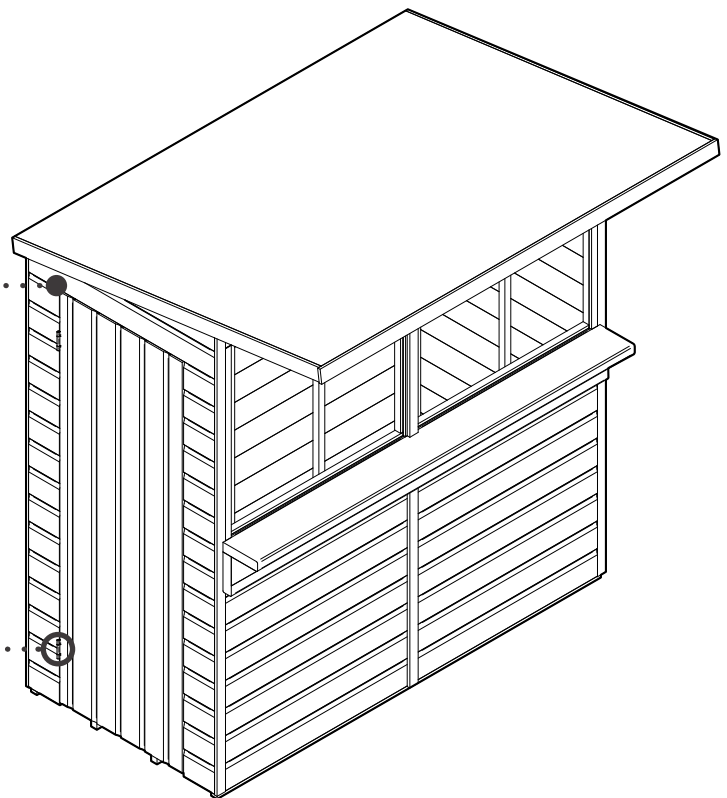
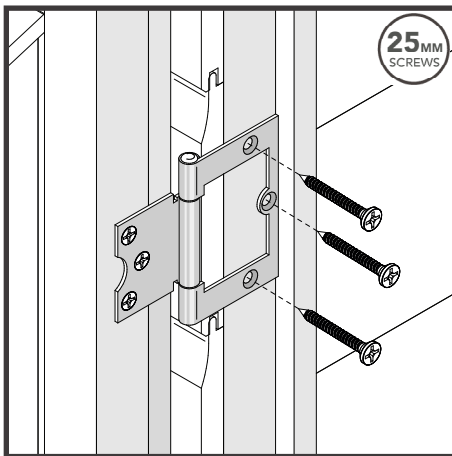
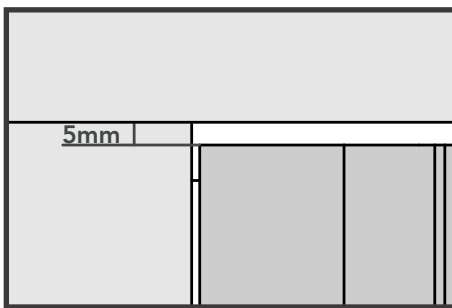

## DOOR INSTALLATION

Position the Door into the door opening, ensuring it is level. Ensure the hinges are up against the framework and on the side, you secured the Door Weather Strip. Secure the hinges in place, allowing a 5mm gap at the top when positioning the Door.

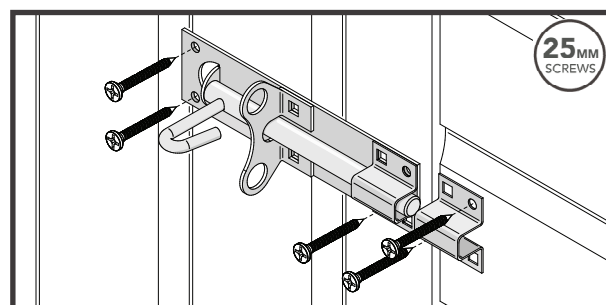
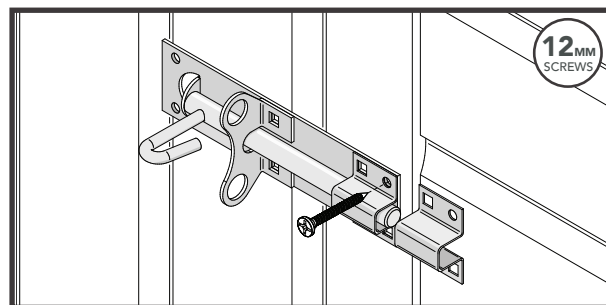
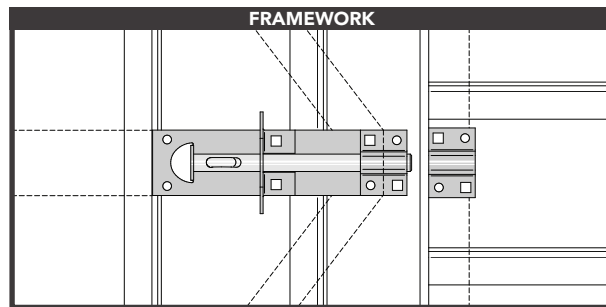
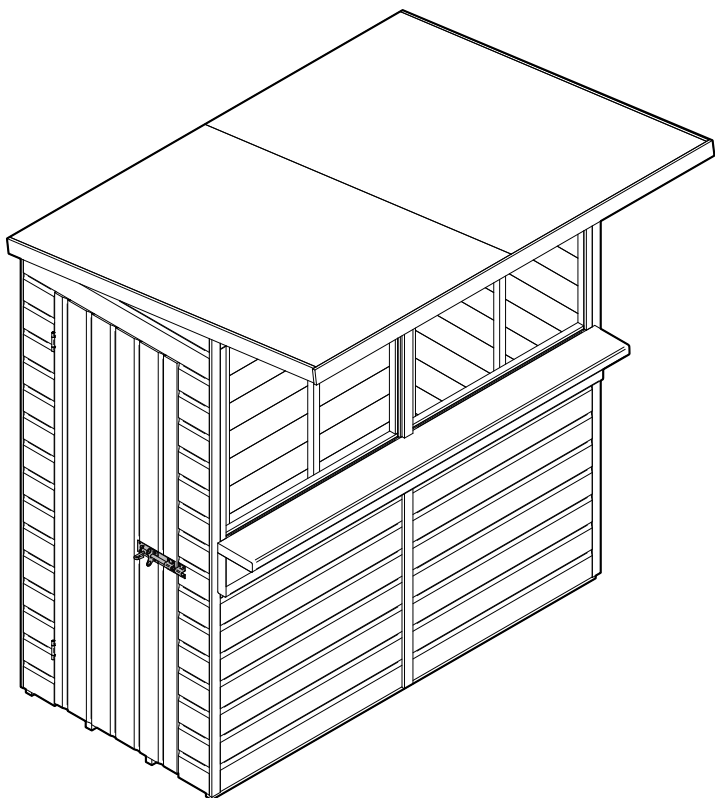

## PADBOLT

Position and secure the Padbolt to the Doors framework. The front hole on the Padbolt will require the smaller screw to be secured to the Door. Secure the Receiver to the Door Panels framework as shown above.

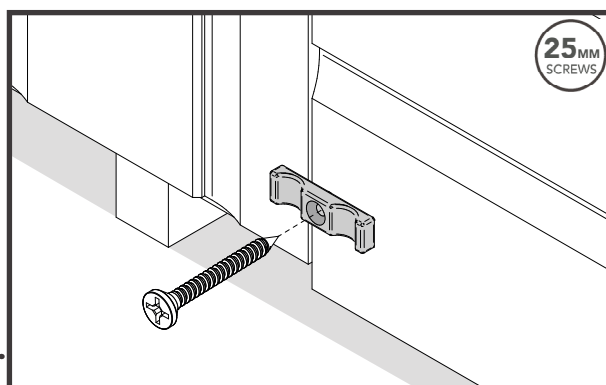
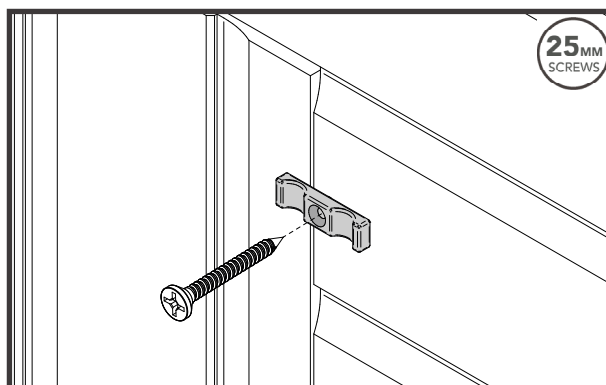
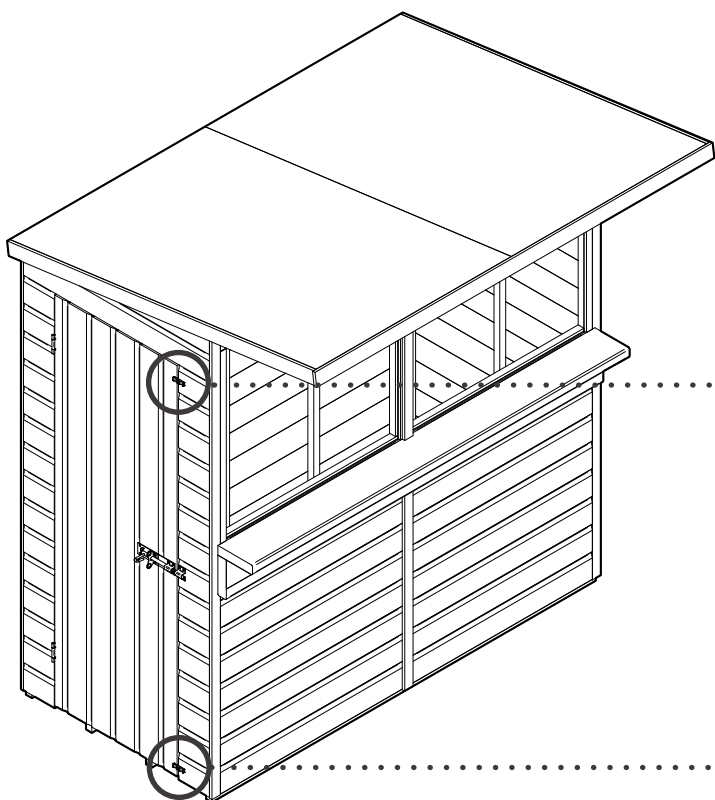

## TURN BUTTONS

Position and secure a turn button to the top and bottom of the Door Panels framework as shown above.

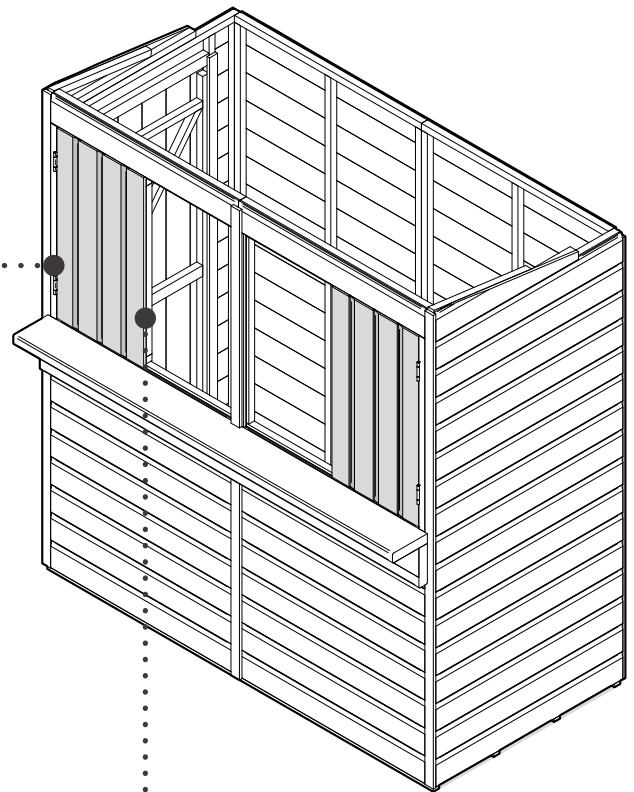
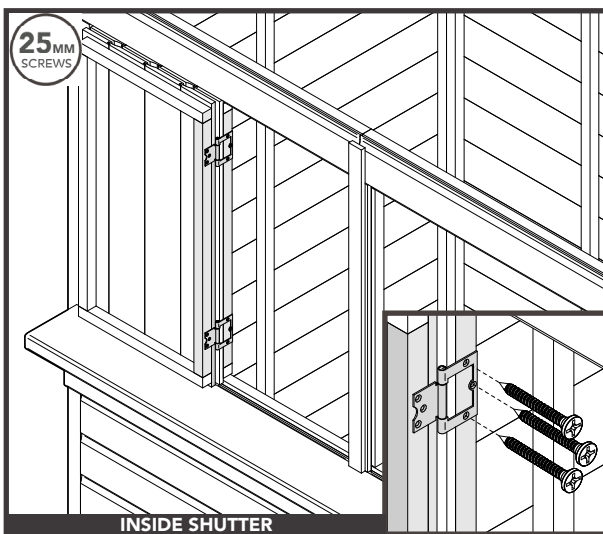
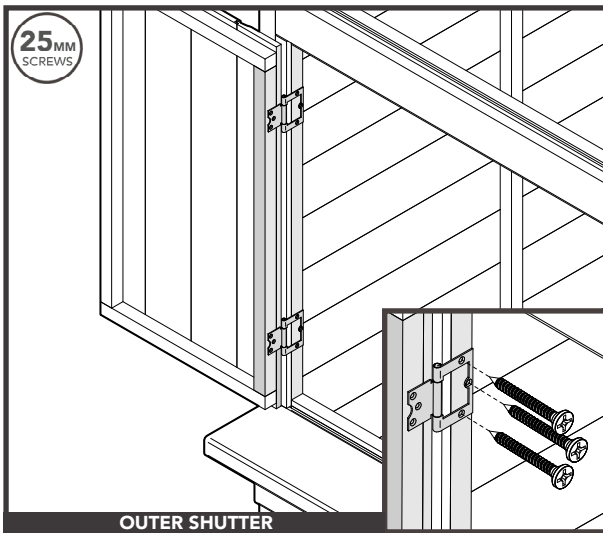
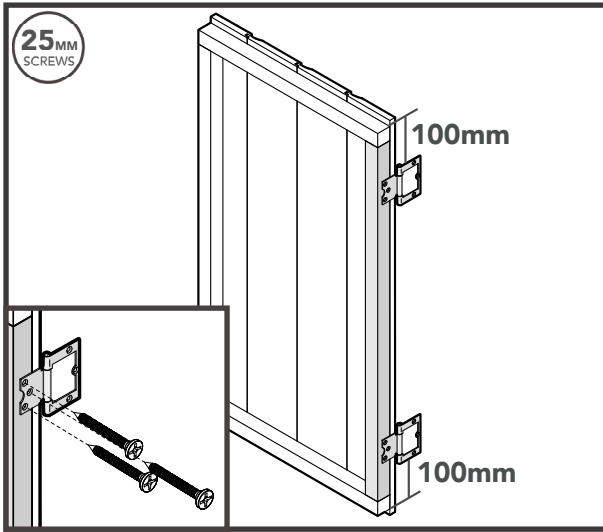

## INSTALLING THE SHUTTERS

Position and secure 2 x hinges onto the Outside Shutter frame with the measurements provided. Secure the shutter to the window panel Framework. Position and secure 2 x hinges onto the Inside Shutter frame (with the lip). Repeat the process for the opposite side.

## STEP 13B: SHUTTER FIXINGS

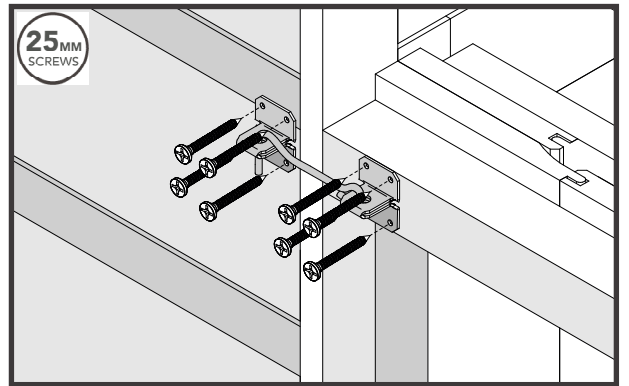
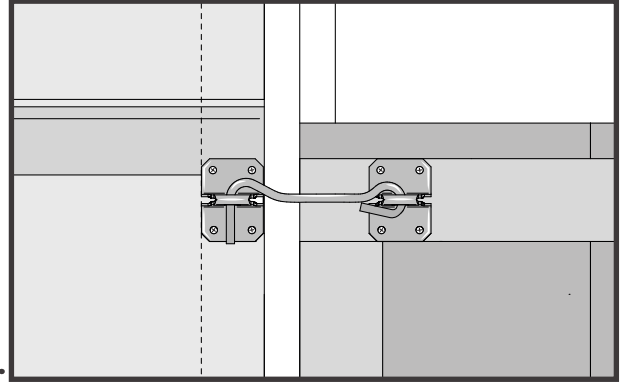
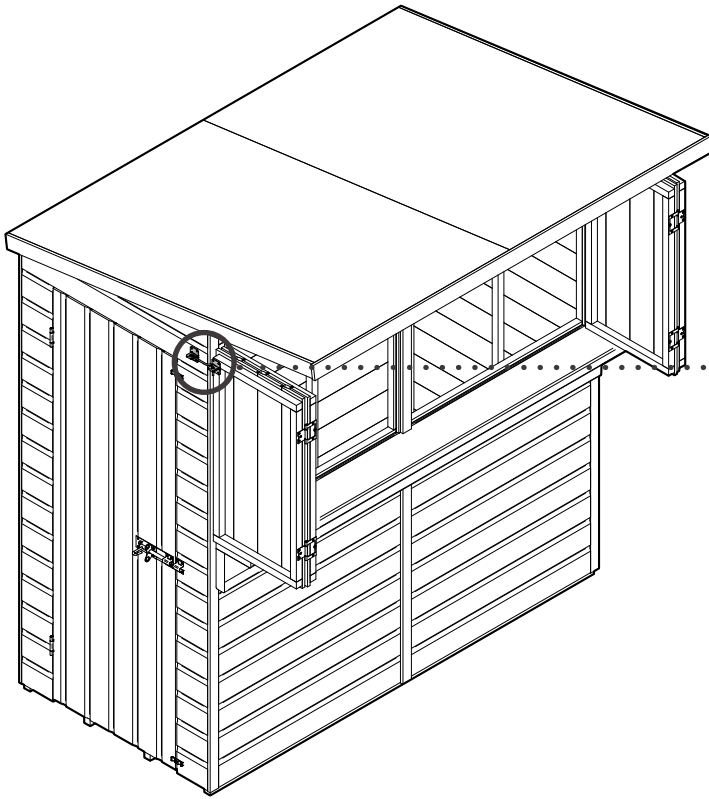

## HOOK AND EYE

Line up the hook and eye and mark the edges with a pencil for guidance. **Ensure the hook and eye are level and secured to the framework behind. Position and Secure your hook to the inside of the Inner Shutter and secure the receiver to the side panel, into the framework behind.** Repeat the process for both sides.

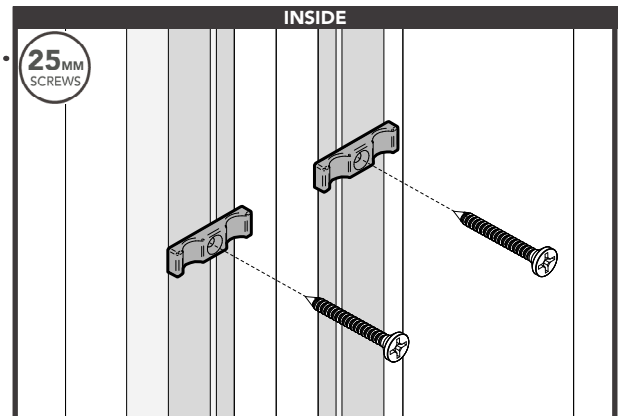
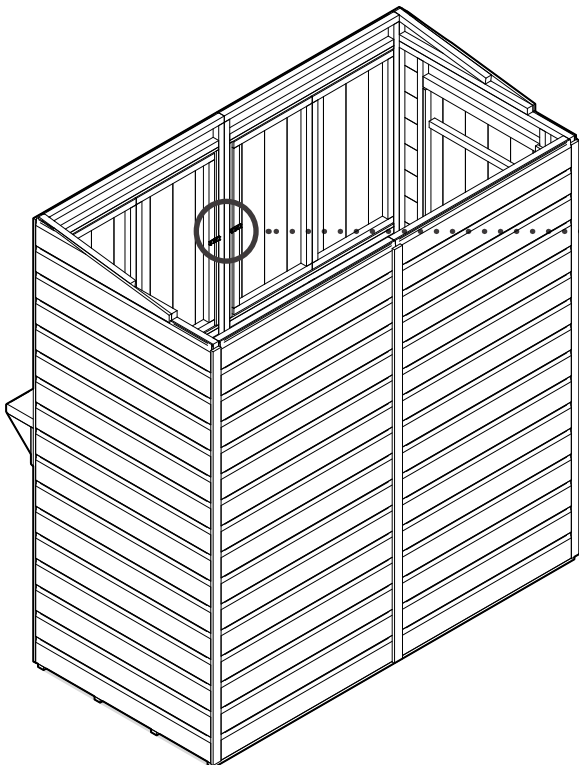

## TURN BUTTONS

**Position and secure a turn button** onto each Inside Shutter as shown above.

**CHECK YOU HAVE ALL YOUR PARTS PRIOR TO ASSEMBLY.**

(The parts do not have codes on them. They are listed below should you need to order one.)

The components provided may be heavy. Please lift with caution and with a minimum of 2 people.

<b>6"x3" PENT SHIPLAP YARD BAR (SPP63YBAR)</b>			
<b>Label</b>	<b>Part Code</b>	<b>Description</b>	<b>No.</b>
1	<i>120400120PAI45PT</i>	Angled Block (120x40x120mm)	3
2	<i>165401794PPT</i>	Batten (165x40x1794mm)	2
3	<i>28120765PPT</i>	Strip (28x12x765mm)	2
4	<i>28120791PPT</i>	Strip (28x12x791mm)	2
5	<i>28120829PPT</i>	Strip (28x12x829mm)	4
6	<i>28121637PPT</i>	Strip (28x12x1637mm)	1
7	<i>28280466PT</i>	Batten (28x28x466mm)	2
8	<i>28281858PT</i>	Batten (28x28x1858mm)	2
9	<i>38121710PPT</i>	Strip (38x12x1710mm)	1
10	<i>40120828PPT</i>	Strip (40x12x828mm)	1
11	<i>40120890PPT</i>	Strip (40x12x890mm)	1
12	<i>45280466PT</i>	Batten (45x28x466mm)	1
13	<i>45281770PPT</i>	Batten (45x28x1770mm)	1
14	<i>56120791PPT</i>	Strip (56x12x791mm)	1
15	<i>59121471PPT</i>	Strip (59x12x1471mm)	2
16	<i>59121892PPT</i>	Board (59x12x1892mm)	1
17	<i>MSPDR</i>	Modular Shed Pressure Treated Door	1
18	<i>MSTGFL63</i>	Modular shed T&G Floot 6x3	1
19	<i>OSB92914718</i>	OSB (929x1471x8mm)	2
20	<i>P40121823PT</i>	Strip (40x12x1823mm)	3
21	<i>P40121940PT</i>	Strip (40x12x1940mm)	2
22	<i>SPM885PP</i>	Plain Panel (885mm)	3
23	<i>SPM885SDP</i>	Single Door Panel (885mm)	1
24	<i>SPP63GBARIS</i>	6x3 Garden Bar Inner Shutter	2
25	<i>SPP63GBAROS</i>	6x3 Garden Bar Outer Shutter	2
26	<i>SPPGB885WP</i>	Garden Bar Window Panel 885mm	2
27	<i>SPPMLHA3</i>	3' Left Hand Insert	1
28	<i>SPPMRHA3</i>	3' Right Hand Insert	1
Felt - Please contact our aftersales team with your product code if you are missing your felt.			

Use the labelled components on the next page to help identify the part code and description.

18

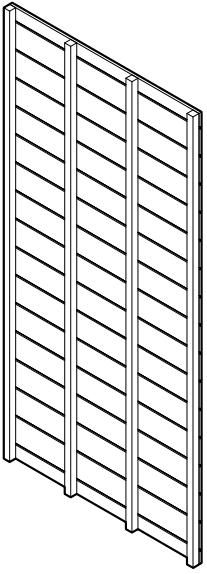

22

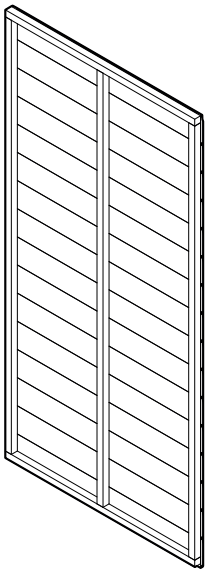

23

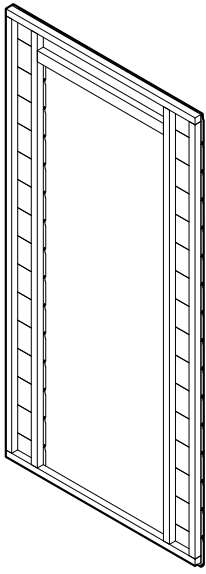

26

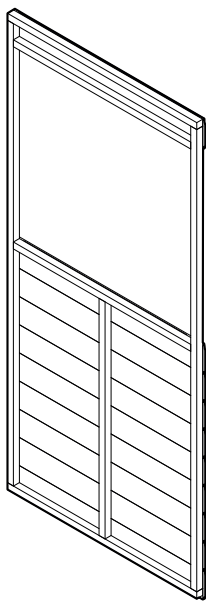

17

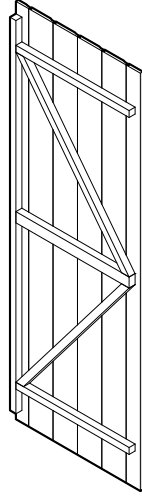

19

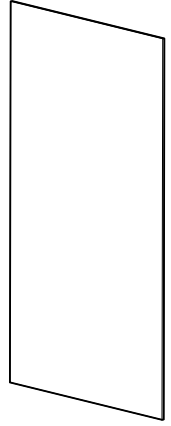

24

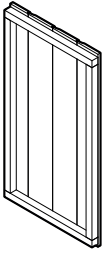

25

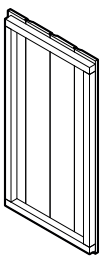

27

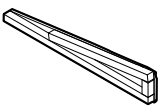

28

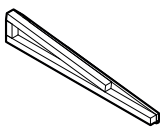

2



8



21



13



9



16



20

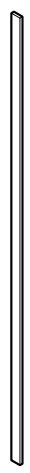

5

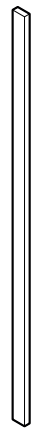

6



7



11



10



14



3

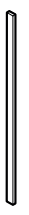

4



12

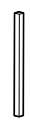

15



1

