

Technical Data Sheet

1000mm Basin & WC Unit (LH & RH)

What's in the box: 1x 545163, 545165, 545168 or 545170 Unit, Basin + Handles

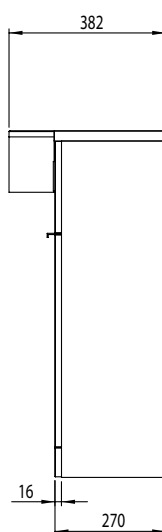
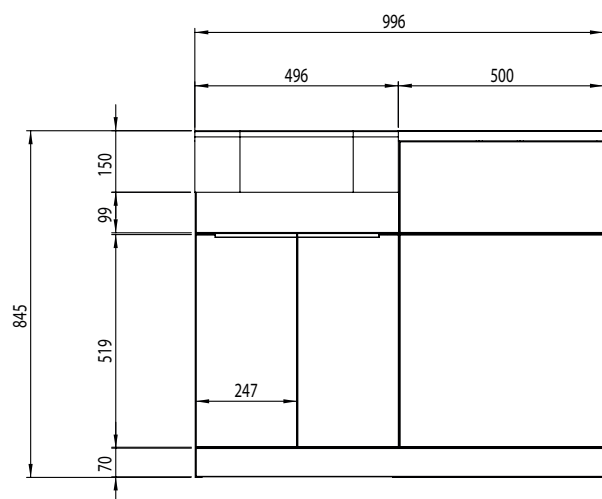

NOTE: LH unit shown, reverse dimensions for RH

Materials

Carcass: Veneered MDF and Plywood

Fascia Components: Veneered MDF and Plywood

**Dimensions are subject to change, customers are advised to measure actual product before commencing installation.

***Fixing point dimensions are for guidance only/the positions of wall fixing must be checked when product is received.

Diagrams not to scale
All dimensions in mm
Tolerance of +/-5mm

FAQs

Q: How big is the plumbing void?

A: 52mm.

Q: Are the handles fitted?

A: Yes, handles are pre-fitted.

Q: Are the hinges soft close?

A: The hinges are both soft close and quick release.

Q: How deep is the unit with door open?

A: Approx 680mm at 90°.

Q: Can the doors be adjusted?

A: The door can be adjusted as detailed in the supplied instructions.

Q: Is the shelf removable?

A: No, the shelf can't be removed.

Q: What is the shelf capacity?

A: Shelf maximum depth: 186mm.

Q: How many shelves are there?

A: There is one shelf and a base within the unit.

Q: Is the shelf adjustable?

A: No, the shelf is at a fixed position.

Q: What is the interior finish of the unit?

A: The unit interior is the same finish as the exterior.

Q: Are the fascias removable?

A: Yes, They are on quick release clips.

Q: Do the fascias come pre-cut and pre-drilled?

A: Yes, the basin fascia comes pre-cut. However the BTW fascia does not come pre-drilled. This must be drilled to suit the cistern/pan selected.

Q: How do I fix the unit to the wall?

A: You can secure it to the wall drilling through the back brace.

Q: Can a wall hung frame be used inside the BTW unit?

A: Yes, only half height frame REF: TR9018 (see brochure for spec).

Q: What cistern is a suitable size for this unit?

A: All Tavistock branded cisterns are suitable for the unit.

Q: What flush button can be used for this unit?

A: All Tavistock branded flush buttons are suitable for the unit.

NOTE: No RAL Code available