



maze

# Athena Solar Light

SOL-ATH-L-GR

SOL-ATH-S-GR

SOL-ATH-L-CH

SOL-ATH-S-CH

USER MANUAL &  
SAFETY INSTRUCTIONS

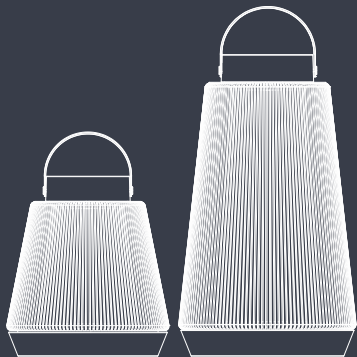



## Athena Solar Light

The Athena series solar/USB-charged LED light is intended for outdoor use. The buyer assumes all responsibility for safety and use that is not in accordance with the user manual & instructions. To ensure your safety and enjoyment, this user's manual and safety instructions were created to provide guidance for the correct use of the product. It is solely the consumer's responsibility to obtain proper instruction from the manual. Additionally, please keep your children away from operating this device. Please always act safely, wisely, and with caution while using our products. Thank you for choosing our products. If you have any questions, comments, or concerns, please feel free to contact us by phone at **01440 710673** , by email at [info@mazeliving.co.uk](mailto:info@mazeliving.co.uk) , or through our contact us page at [www.mazeliving.co.uk/contact](http://www.mazeliving.co.uk/contact)



## PARTS INCLUDED IN DELIVERY

Unpack the box in preparation for assembly. If any of the components are missing, please contact your local retailer.

### ⚠ WARNING

The solar lamp is a product with a built-in battery that operates normally within a temperature range of -15°C to 50°C. For optimal solar power charging, it should be placed in an area that receives direct sunlight.

## ATHENA LARGE

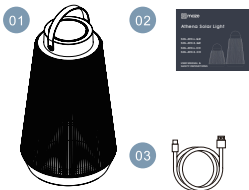

01 Large size main lamp 33.5 x 33.5 x 56CM

02 User manual

03 2 Meter USB cable

## ATHENA SMALL

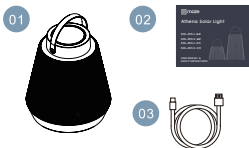

01 Small size main lamp 33.5 x 33.5 x 37CM

02 User manual

03 2 Metre USB cable

## HOW SOLAR LIGHTS WORK

During the day, the solar panel converts solar energy into electricity and stores it in a rechargeable battery. At night, the light turns on automatically through a light-detecting sensor. The duration of the light's illumination will depend on your geographical location, weather conditions, and seasonal light availability.

## ATTENTION FOR THE FIRST TIME USE

Please fully charge the light with solar or a USB cable before your first use. There is a button at the bottom of the light unit; switch it to the "ON" or "A" position. When the ambient environment becomes dark, the solar light will automatically light up. During the day, the solar light will turn off and be charged by the solar panel automatically.

## CHOOSING AN IDEAL LOCATION

Select an outdoor location with full, direct sunshine where the solar panel can receive at least 6 hours of sunlight each day. Shady locations will affect the battery's ability to receive an adequate charge and shorten the working time of the light at night. The chosen location should not be near strong ambient lighting, such as streetlights, as this may cause the light to turn off automatically. The light sensor inside will detect the ambient light and prevent it from turning on.

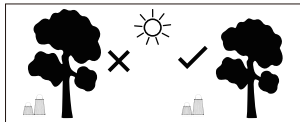

## SPECIFICATIONS

COMPONENTS	PARAMETERS
SOLAR PANEL	GLass
LED LIGHTS	29 LED, 100 lumens
BATTERY	Lithium batteries, 3.7V, 4000mAh

## HOW TO TURN IT ON

### USB TYPE-C PORT

You can easily charge it via the USB Type-C port or the solar panel. Charging with a USB Type-C power adapter or connecting it to a computer's USB port is supported.

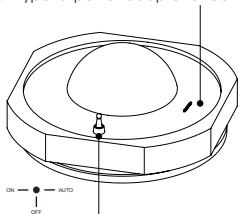

### Power Switch

The switch can adjust the lamp's brightness in three tiers and activate automatic lighting. Simply toggle the switch multiple times to set the lamp's brightness to 30%, 50%, or 100%. Switch to "A" to operate the optical switch.



Three tiers luminance settings  
dimmmable 30% | 50% | 100%  
automatic 80%-30%, full capacity



Running hours after 5 hours of charging by direct sunlight  
setting 1 light intensity 30% | duration 12h  
setting 2 light intensity 50% | duration 8h  
setting 3 light intensity 100% | duration 5h



Fully charged by USB-C  
setting 1 light intensity 30% | duration 60h  
setting 2 light intensity 50% | duration 48h  
setting 3 light intensity 100% | duration 32h

## TROUBLESHOOTING

The light is not as bright as normal

- Please try to charge it with the USB cable.
- Please check the switch and adjust it to a higher luminance level.

The light turns on during the day

Please check the switch to see if it is on the "ON" side. If it is, switch it to the middle - "OFF" or "A" for auto.

## UNLOCK THE LAMP TOP FOR USB CABLE CHARGING

The Athena series outdoor lantern was designed with a removable lamp top, making it easy to charge with a USB cable. Simply follow the steps below.

- 01 Spin counterclockwise, align the icon "▼" to the "○" to release the lamp top and charge it with USB cable.

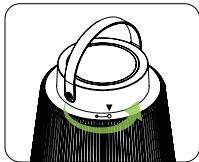

- 02 Align the icon "▼" to "○" and spin clockwise aligning the icon "▼" to the "●" until the lamp top is locked on the lantern.

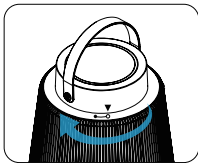
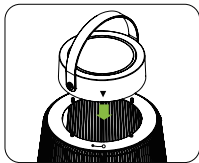



**maze**

CONTACT INFO:

Tel: 01440 710673

Email: [info@mazeliving.co.uk](mailto:info@mazeliving.co.uk)